

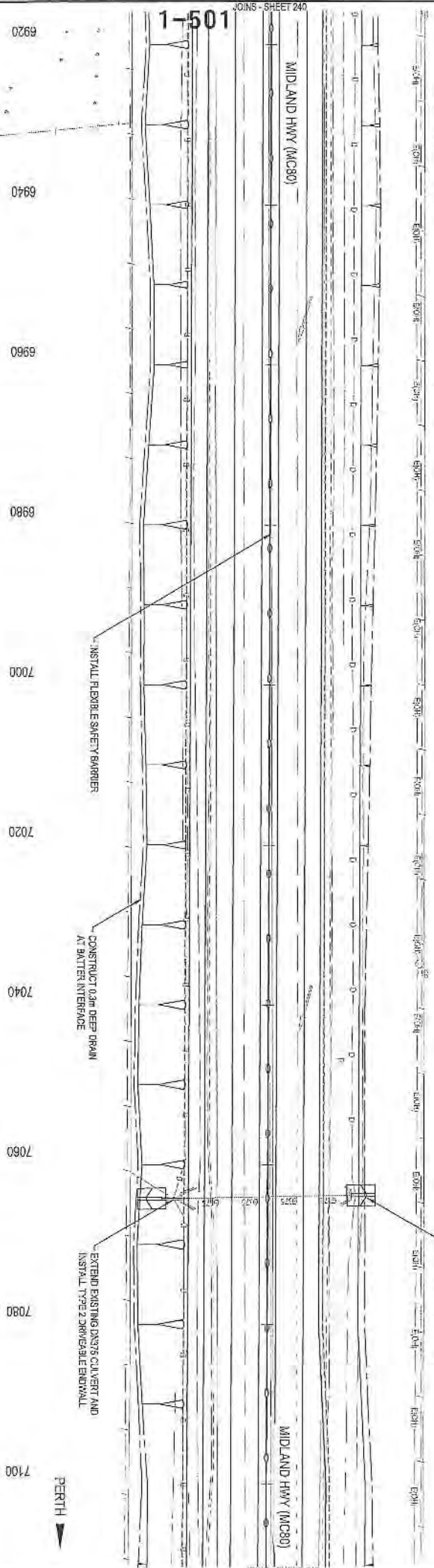

A. M. R. GUNN
 D. - 6396666
 TITLE - 12865712

CAMPBELL TOWN



1-501

A. M. R. GUNN
 D. - 6396666
 TITLE - 12865712

LEGEND	
	PIONEER AVENUE TREES
	PIONEER AVENUE TREES TO BE REMOVED
	THREATENED FLORA
	THREATENED FLORA TO BE REMOVED
	POTENTIAL HABITAT TREE
	HABITAT TREE TO BE REMOVED
	POWRANNA ARTIFACT TO BE PROTECTED
	THREATENED VEGETATION TO BE RETAINED
	PROPOSED PROPERTY FENCILINE

No.	Amendment Description	Initials	Date
C	DEVELOPMENT APPLICATION ISSUE	N. DWYER	04/11/2016
B	DEVELOPMENT APPLICATION ISSUE	N. DWYER	01/11/2016
A	PRELIMINARY DESIGN	N. DWYER	13/10/2016

SCALES

1:500 (A3)

5 10 15 20 METERS

5 10 15 20 METERS

Co-ordinate System: MGA ZONE 55

Height datum: AHD

DESIGNED BY: LALLEY

REVIEWED BY: N. DWYER

Department of State Growth

MIDLAND HIGHWAY (A0087)

EPPING FOREST TO POWRANNA

ROAD IMPROVEMENTS AND SAFETY UPGRADES

DEVELOPMENT APPLICATION

GENERAL ARRANGEMENT - DRG 59 OF 63

CONTRACT NO.	2867	DRAWING	H51614-0241	PRINTED DATE	17:40:16, 16, 2016 PM	SHEET NO.	241
REGISTRATION NUMBER				A0087.037		REVISION C	



A.M.R. GUINN
I.D. - 6309556
TITLE - 128657/2

A.M.R. GUINN
I.D. - 7062231
TITLE - 128657/1

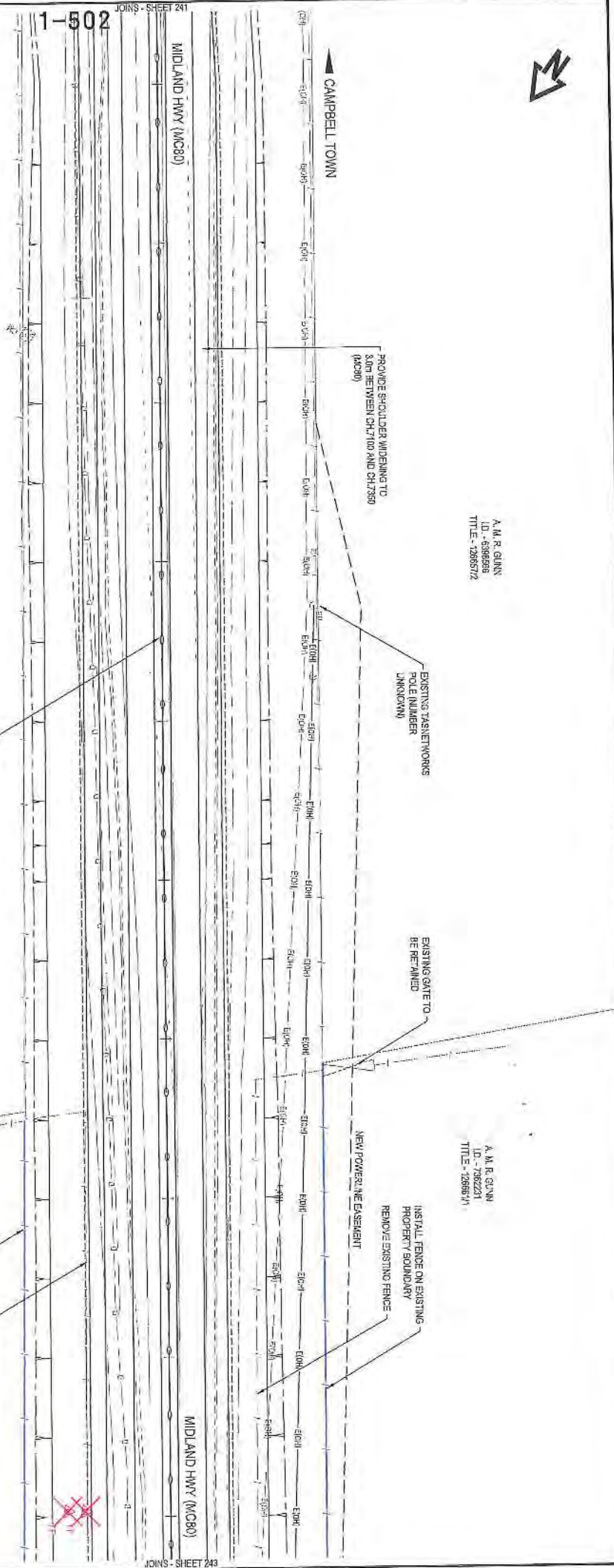

LEGEND	
	PIONEER AVENUE TREES
	PIONEER AVENUE TREES TO BE REMOVED
	THREATENED FLORA
	THREATENED FLORA TO BE REMOVED
	POTENTIAL HABITAT TREE
	HABITAT TREE TO BE REMOVED
	POWRANNA ARTIFACT TO BE PROTECTED
	THREATENED VEGETATION TO BE RETAINED
	PROPOSED PROPERTY FENCELINE

A.M.R. GUINN
I.D. - 6309556
TITLE - 128657/1

A.M.R. GUINN
I.D. - 7062231
TITLE - 128657/1

<p>Department of State Growth</p> <p>MIDLAND HIGHWAY (A0087)</p> <p>EPPING FORESTS TO POWRANNA</p> <p>ROAD IMPROVEMENTS AND SAFETY UPGRADES</p> <p>DEVELOPMENT APPLICATION</p> <p>GENERAL ARRANGEMENT - DRG 40 OF 63</p>		<p>CONTRACT No.</p> <p>2387</p>	<p>DRAWING</p> <p>H319197-C242</p>	<p>PRINTED DATE</p> <p>17-Jul-16, 3:55 PM</p>	<p>SHEET No.</p> <p>242</p>
<p>DESIGNED</p> <p>LALEN</p>	<p>REVIEWED</p> <p>NDWYER</p>	<p>REGISTRATION NUMBER</p> <p>A0087.037</p>	<p>REVISION C</p>	<p>AD original This sheet may be prepared using vector and may be incomplete if copied</p>	



A. M. R. GILM
 ID - 798231
 TITLE - 28881/1

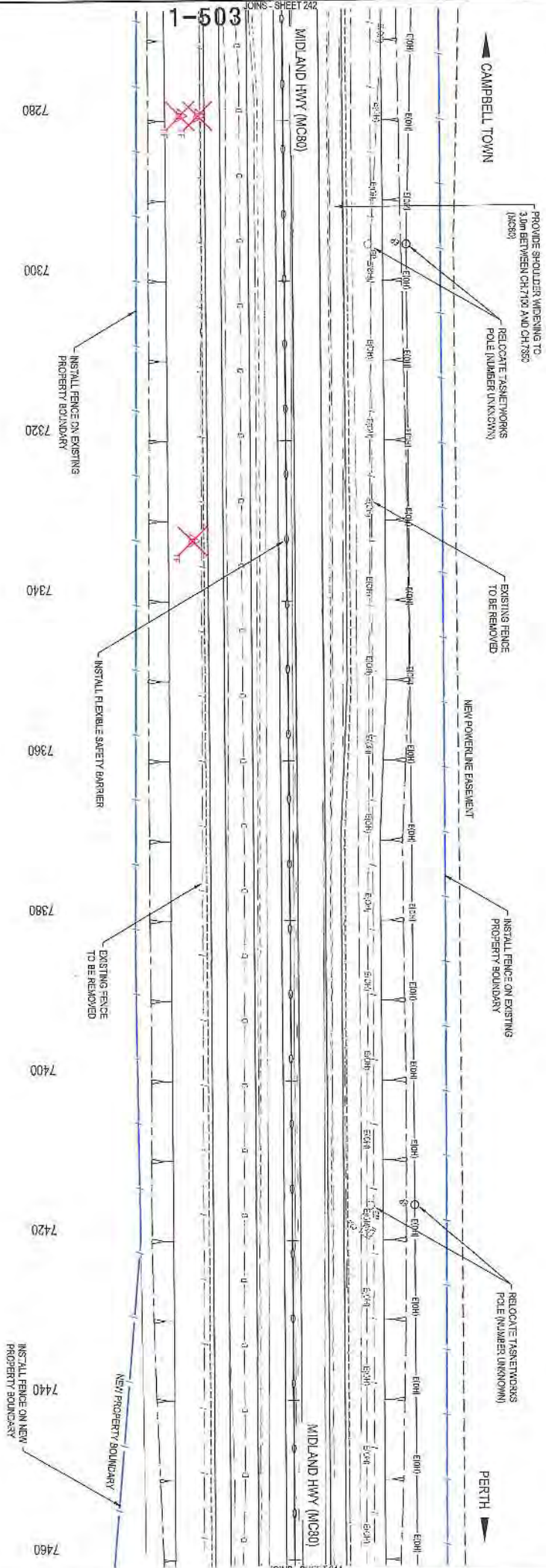

No.	Amendment Description	Initials	Date
A	PRELIMINARY DESIGN		13/10/2016
B	DEVELOPMENT APPLICATION SS/E		17/11/2016
C	DEVELOPMENT APPLICATION SS/E		04/11/2016
D	DEVELOPMENT APPLICATION SS/E		N.D.WYER

SCALES

1:500 (A3)

5 0 5 10 15 20

SCALE IN METRES - 1:500

CONVENTIONAL SYMBOL: MGA ZONE 55

HEIGHT DATUM: A.M.D.

DESIGNED: L. ALLEN

REVIEWED: N. DWYER

Department of State Growth

MIDLAND HIGHWAY (A0087)

EPIND FORESTS TO POWRANNA ROAD IMPROVEMENTS AND SAFETY UPGRADES DEVELOPMENT APPLICATION GENERAL ARRANGEMENT - DRG 41 OF 63

CONTRACT No. 2887

DRAWING No. HR/191-0245

PRINTED DATE: 17-Nov-16, 5:56 PM

REGISTRATION NUMBER: A0087.037

SHEET No. 243

REVISION C

LEGEND	
	PIONEER AVENUE TREES
	PIONEER AVENUE TREES TO BE REMOVED
	THREATENED FLORA
	THREATENED FLORA TO BE REMOVED
	POTENTIAL HABITAT TREE
	HABITAT TREE TO BE REMOVED
	POWRANNA ARTIFACT TO BE PROTECTED
	THREATENED VEGETATION TO BE RETAINED
	PROPOSED PROPERTY FENCE LINE



A.M.R. GUNN
 I.D. - 7382231
 TITLE - 125866/1

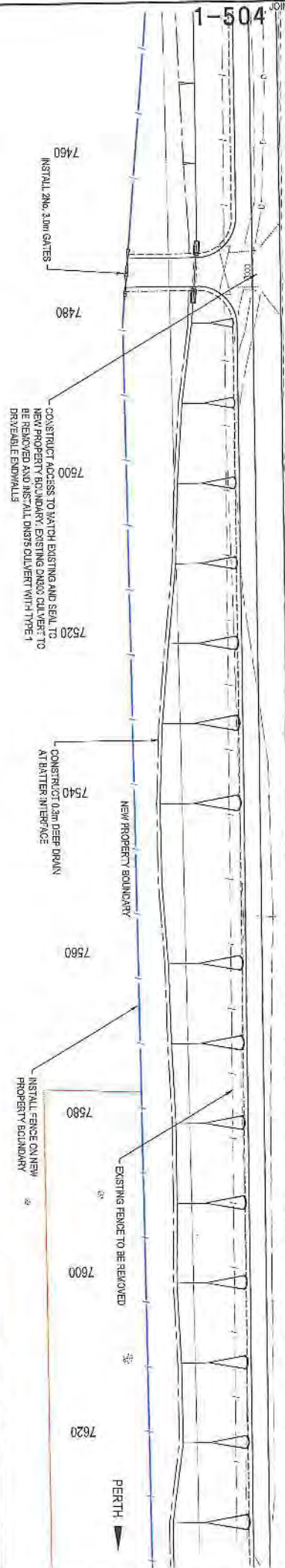
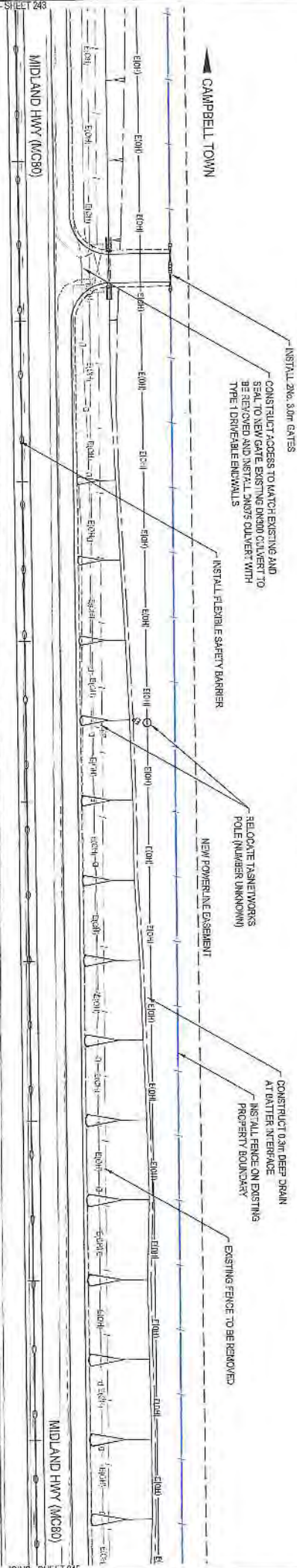

No.	Amendment Description	Initials	Date
A	PRELIMINARY DESIGN	N.D.WYER	12/10/2016
B	DEVELOPMENT APPLICATION ISSUE	N.D.WYER	09/11/2016
C	DEVELOPMENT APPLICATION ISSUE	N.D.WYER	04/11/2016

SCALES
 1:500 (A3)
 SCALE 1:1000 (A4)
 SCALE 1:1500 (A5)

DESIGNED: LAUREN
 REVIEWED: N.D.WYER

Department of State Growth
 MIDLAND HIGHWAY (A0087)
 EPPING FOREST TO POWRANNA
 ROAD IMPROVEMENTS AND SAFETY UPGRADES
 DEVELOPMENT APPLICATION
 GENERAL ARRANGEMENT - DRG 42 OF 63

CONTRACT NO. 2987	DRIVING H918191-2544	PRINTED DATE 17-Nov-16, 3:55 PM	SHEET NO. 244
REGISTRATION NUMBER A0087.037		REVISION C	

LEGEND	
	PIONEER AVENUE TREES
	PIONEER AVENUE TREES TO BE REMOVED
	THREATENED FLORA
	THREATENED FLORA TO BE REMOVED
	POTENTIAL HABITAT TREE
	HABITAT TREE TO BE REMOVED
	POWRANNA ARTIFACT TO BE PROTECTED
	THREATENED VEGETATION TO BE RETAINED
	PROPOSED PROPERTY BOUNDLINE



A. M. R. GILIN
 I.D. - 7582231
 TITLE - 22085/14

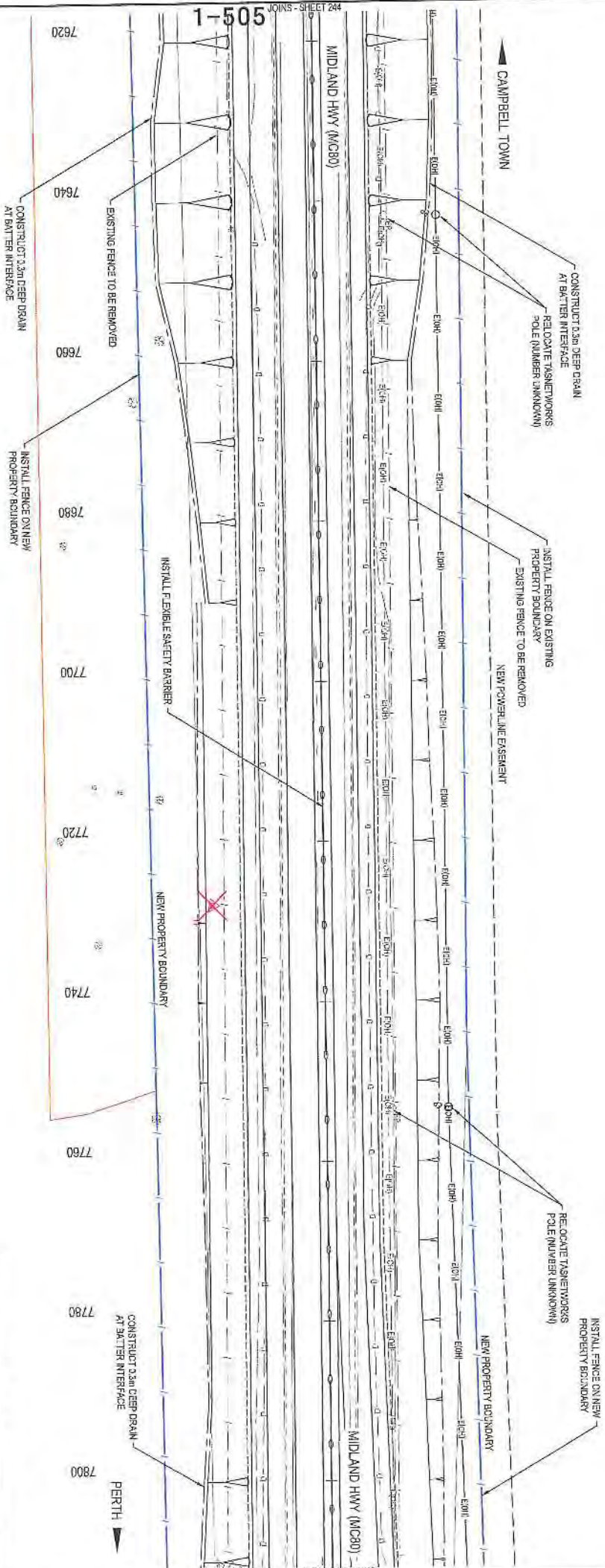

No.	Amendment Description	Initials	Date
A.	PRELIMINARY DESIGN	N.D.WYER	13/10/2016
B.	DEVELOPMENT APPLICATION ISSUE	N.D.WYER	02/11/2016
C.	DEVELOPMENT APPLICATION ISSUE	N.D.WYER	04/11/2016

SCALES

1:500 (A3)

SCALE IN METERS - 1:50

DESIGNED: L. ALLEN
 REVIEWED: N.D.WYER

Department of State Growth

MIDLAND HIGHWAY (A0087)
 EPPING FOREST TO POWRANNA
 ROAD IMPROVEMENTS AND SAFETY UPGRADES
 DEVELOPMENT APPLICATION
 GENERAL ARRANGEMENT - DRG 43 OF 63

LEGEND	
	PIONEER AVENUE TREES
	PIONEER AVENUE TREES TO BE REMOVED
	THREATENED FLORA
	THREATENED FLORA TO BE REMOVED
	POTENTIAL HABITAT TREE
	HABITAT TREE TO BE REMOVED
	POWRANNA ARTIFACT TO BE PROTECTED
	THREATENED VEGETATION TO BE REMOVED
	PROPOSED PROPERTY FENCELINE

CONTRACT NO.	2387	DRAWINGS	HP16191-C246	PRINTED DATE	17/Nov/16 3:55 PM	SHEET NO.	245
REGISTRATION NUMBER				A0087.037		REVISION C	



A. M. R. GILIN
 I.D. - 7382231
 TITLE - 1288711

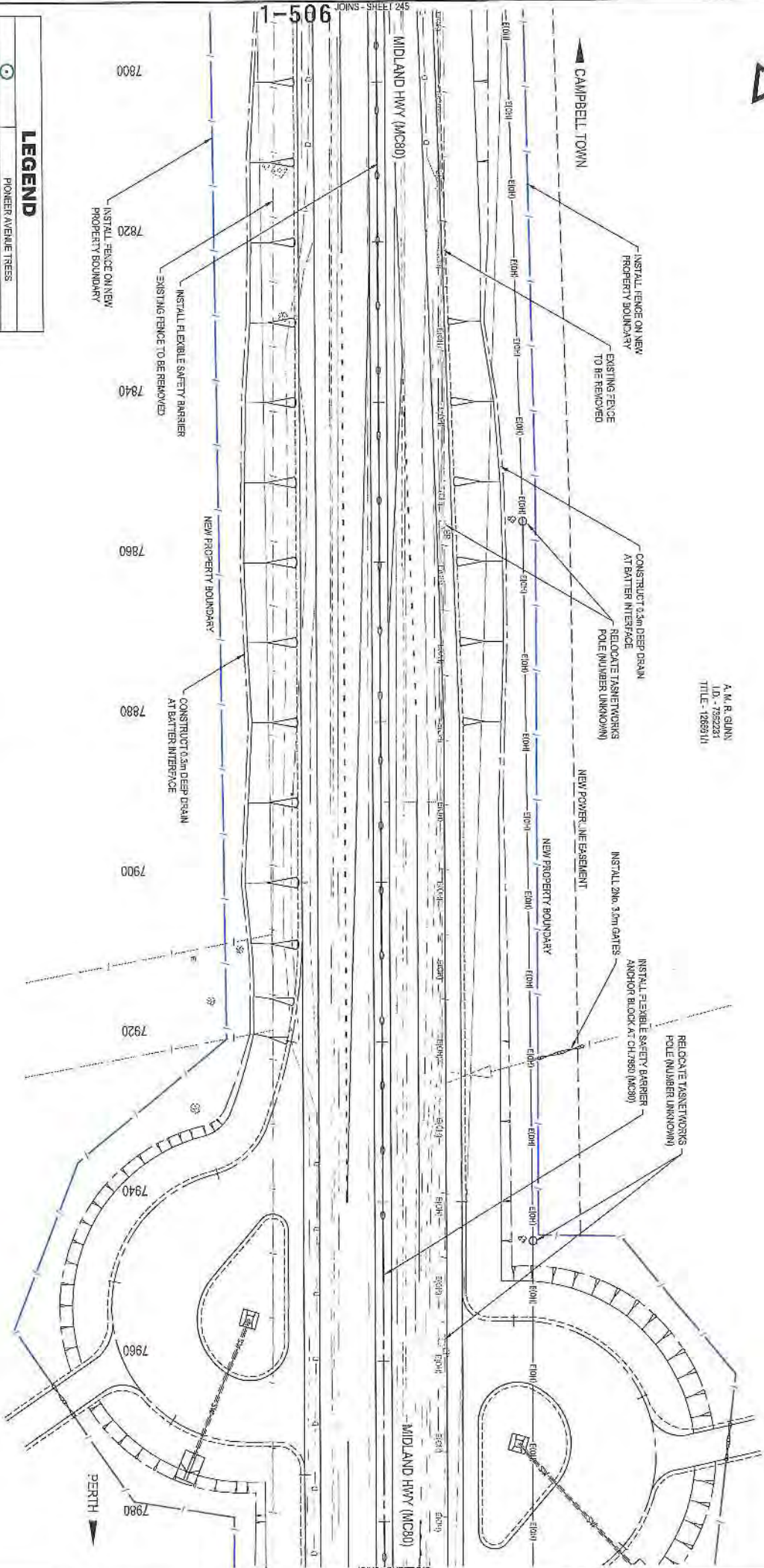

LEGEND	
	PIONEER AVENUE TREES
	PIONEER AVENUE TREES TO BE REMOVED
	THREATENED FLORA
	THREATENED PLANTS TO BE REMOVED
	POTENTIAL HABITAT TREE
	HABITAT TREE TO BE REMOVED
	POWRANNA ARTIFACT TO BE PROTECTED
	THREATENED VEGETATION TO BE RETAINED
	PROPOSED PROPERTY FENCE/LINE

A. M. R. GILIN
 I.D. - 7382231
 TITLE - 1288711

SCALES	
1:500 (A3)	1" = 50'
SCALE IN METRES: 1:500	1" = 12.5m

DESIGNED		REVIEWED	
LALLEN		NADWYER	

Department of State Growth	
MIDLAND HIGHWAY (A0087)	ROAD IMPROVEMENTS AND SAFETY UPGRADES DEVELOPMENT APPLICATION - DRG 44 OF 63

CONTRACT NO.		DRAWING		PRINTED DATE		SHEET No.	
2287		H1816191-0216		17-Nov-16, 5:56 PM		246	
		REGISTRATION NUMBER				REVISION C	
		A0087.037					

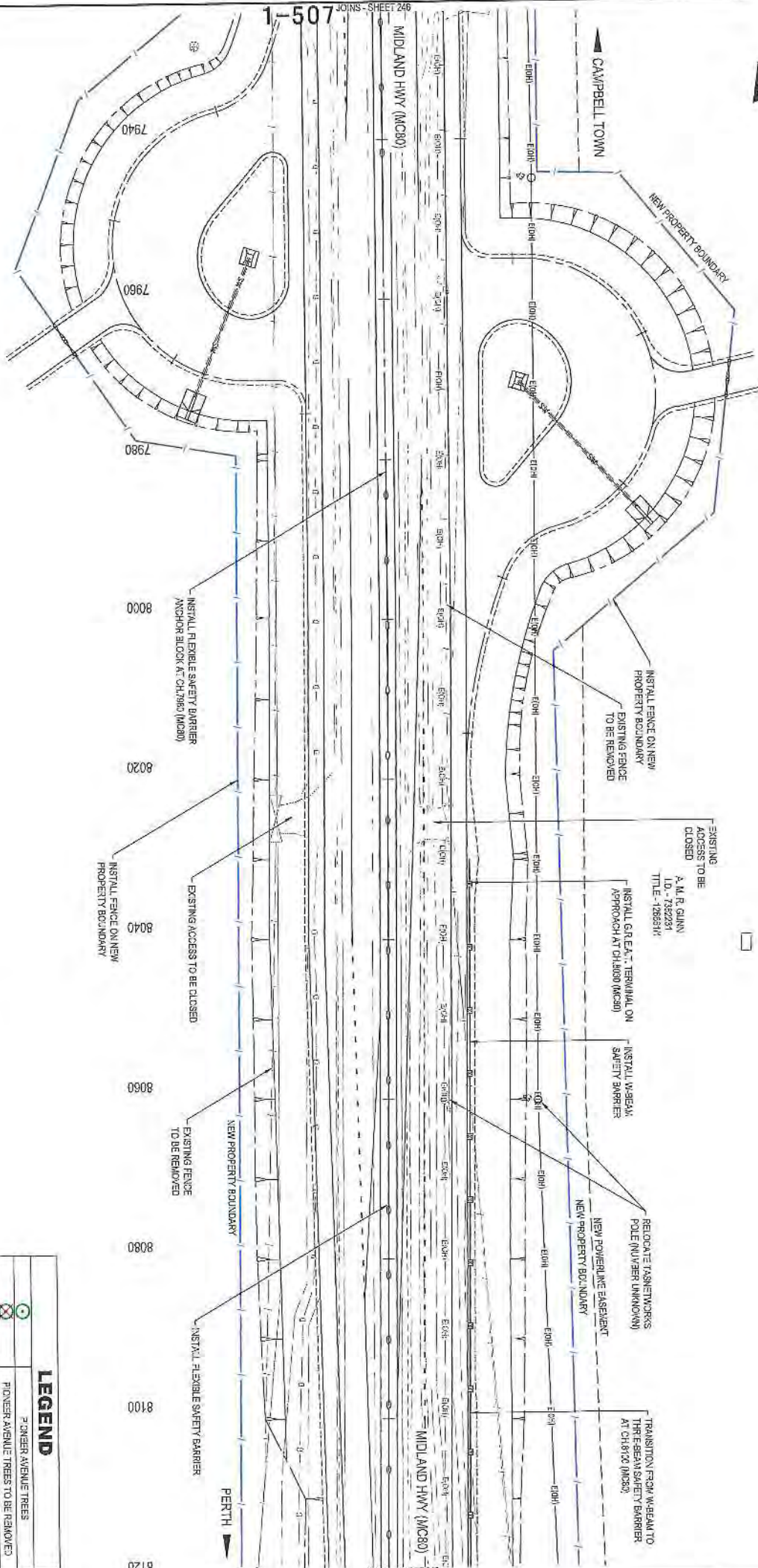

No.	Amendment Description	Issue	Date
A	PRELIMINARY DESIGN	1/11/2016	23/10/2016
B	DEVELOPMENT APPLICATION ISSUE	N/D/VER	02/12/2016
C	DEVELOPMENT APPLICATION ISSUE	N/D/VER	02/12/2016

SCALES

1:500 (A3)

SCALE 1:1000 (A4)

SCALE 1:1500 (A5)

SCALE 1:2000 (A6)

SCALE 1:2500 (A7)

SCALE 1:3000 (A8)

SCALE 1:4000 (A9)

SCALE 1:5000 (A10)

SCALE 1:6000 (A11)

SCALE 1:7000 (A12)

SCALE 1:8000 (A13)

SCALE 1:9000 (A14)

SCALE 1:10000 (A15)

DESIGNED: LALLEN

REVIEWED: N/D/VER

Department of State Growth

MIDLAND HIGHWAY (A0087)

EPPING FOREST TO POWBRANNA

ROAD IMPROVEMENTS AND SAFETY UPGRADES

DEVELOPMENT APPLICATION

GENERAL ARRANGEMENT - DRG 45 OF 63

CONTRACT NO. 2487

DRAWING: HB16181-0247

PRINTED DATE: 27/NOV/16, 3:55 PM

REGISTRATION NUMBER: A0087.037

SHEET NO. 247

REVISION C

A.M. R. GUNN
 I.D. - 7362237
 TITLE - 12663111

LEGEND

	7' CHENER AVENUE TREES
	PIONEER AVENUE TREES TO BE REMOVED
	THREATENED FLORA
	THREATENED FLORA TO BE REMOVED
	POTENTIAL HABITAT TREE
	HABITAT TREE TO BE REMOVED
	POWBRANNA ARTIFACT TO BE PROTECTED
	THREATENED VEGETATION TO BE RETAINED
	PROPOSED PROPERTY FENCELINE

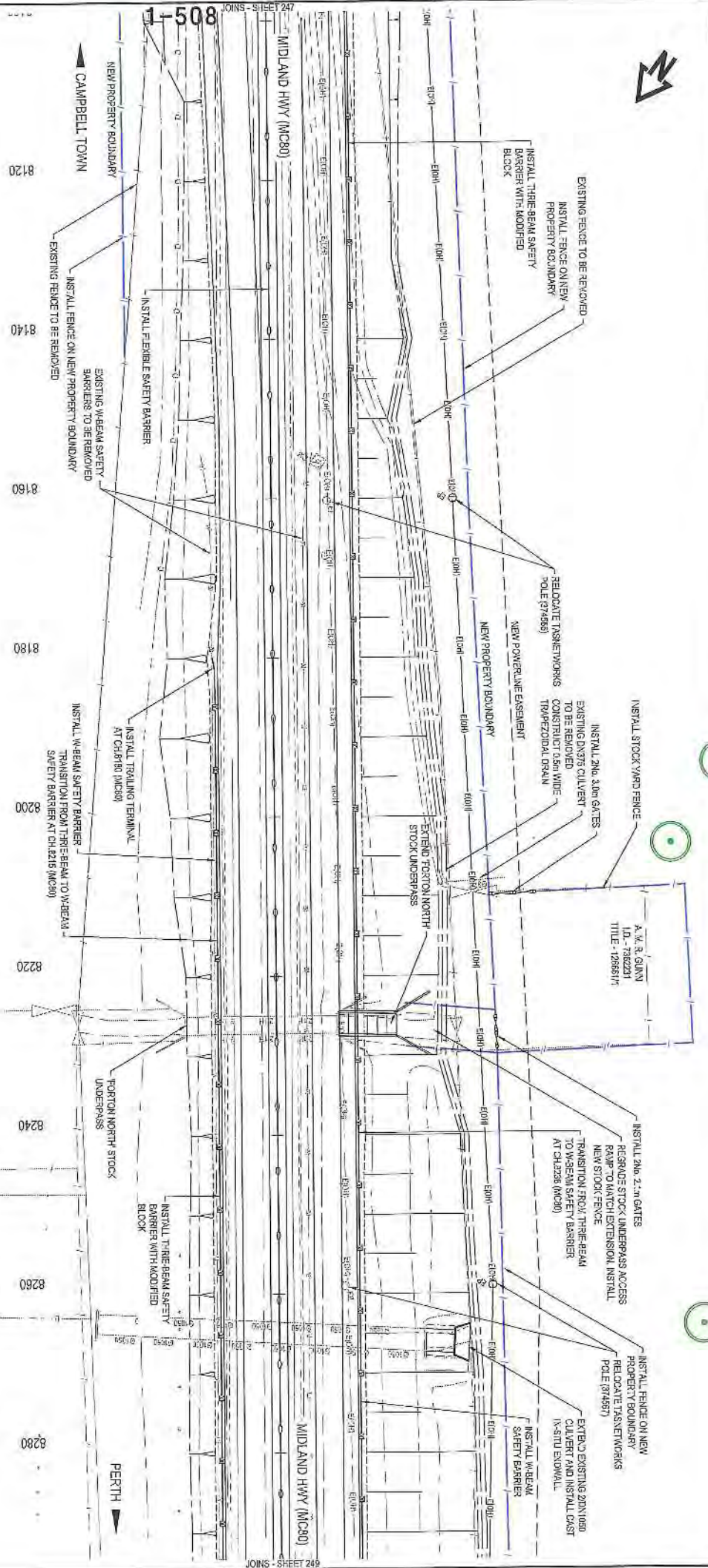

LEGEND

	PIONEER AVENUE TREES
	PIONEER AVENUE TREES TO BE REMOVED
	THREATENED FLORA
	THREATENED FLORA TO BE REMOVED
	POTENTIAL HABITAT TREE
	HABITAT TREE TO BE REMOVED
	POWRANNA ARTIFACT TO BE PROTECTED
	THREATENED VEGETATION TO BE RETAINED
	PROPOSED PROPERTY FENCELINE

A. M. R. GUNN
I.D. - 73622/17
TITLE - 2686/17

No.	Amendment	Discipline	Author	Date
1			NADWYER	13/10/2026
2			NADWYER	04/12/2026
3			NADWYER	01/12/2026
4			NADWYER	13/10/2026

SCALES

1:500 (A3)

SCALE IN METRES - 1:500

Horizontal Datum: AHD.

DESIGNED: LALLEN

REVIEWED: NADWYER

Department of State Growth

MIDLAND HIGHWAY (A00097)
EPPING FOREST TO POWRANNA
ROAD IMPROVEMENTS AND SAFETY UPGRADES
DEVELOPMENT APPLICATION
GENERAL ARRANGEMENT - DRG 46 OF 63

CONTRACT No.	2487	DRAWING	18/1616-0248	PRINTED DATE	17-Nov-16, 3:58 PM	SHEET No.	248
REGISTRATION NUMBER				A0087.037		REVISION C	

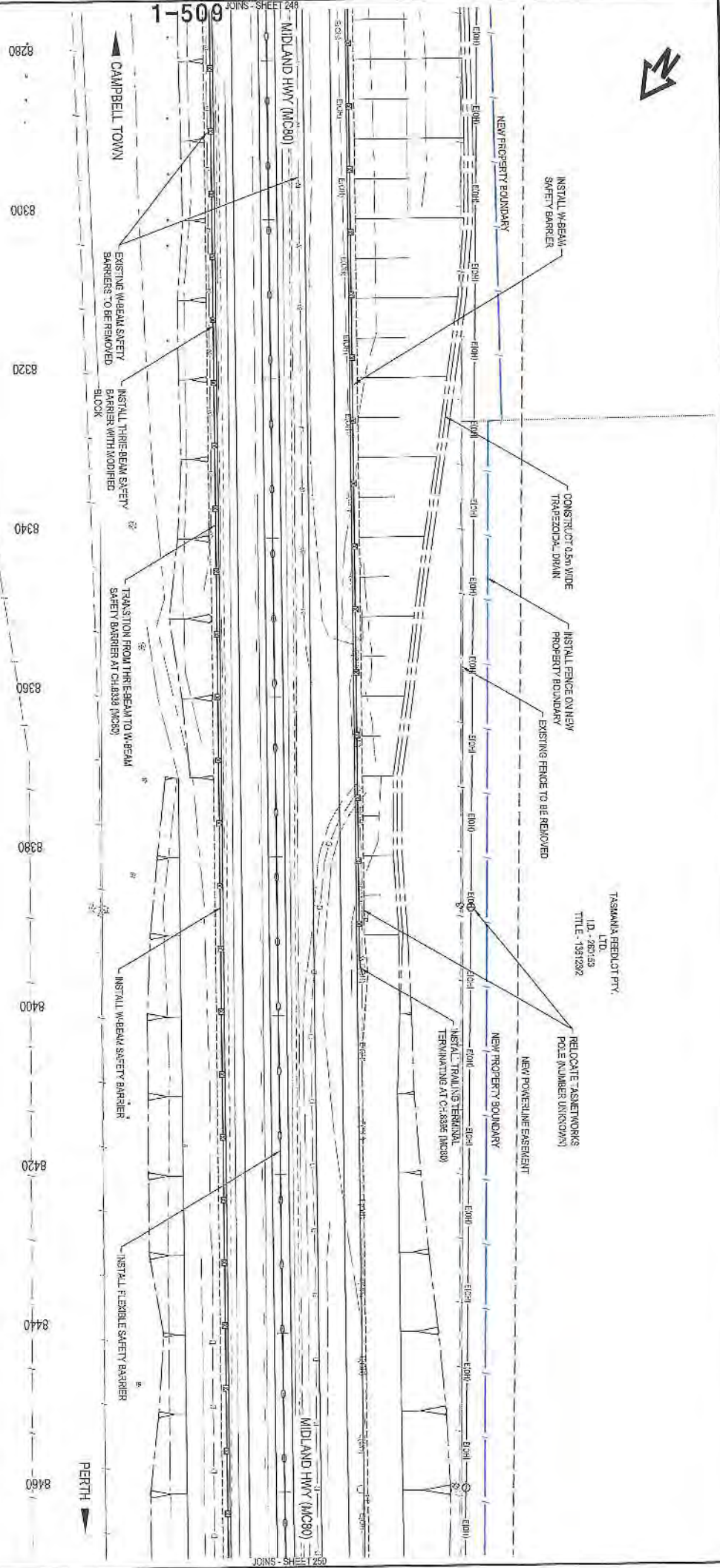

1-509

CAMPBELL TOWN

TASMANIA FEEDLOT PTY. LTD.
I.D. - 2851433
TITLE - 15412382

TASMANIA FEEDLOT PTY. LTD.
I.D. - 2861531
TITLE - 15412381

LEGEND	
	PIONEER AVENUE TREES
	PIONEER AVENUE TREES TO BE REMOVED
	THREATENED FLORA
	THREATENED FLORA TO BE REMOVED
	POTENTIAL HABITAT TREE
	HABITAT TREE TO BE REMOVED
	POWANANNA ARTIFACT TO BE PROTECTED
	THREATENED VEGETATION TO BE RETAINED
	PROPOSED PROPERTY ENCLOSURE

Amendment Description		Date
A	PRELIMINARY DESIGN	13/01/2016
B	DEVELOPMENT APPLICATION ISSUE	07/11/2016
C	DEVELOPMENT APPLICATION ISSUE	04/11/2016
Amendment Description		
This sheet may be prepared using color and may be incomplete if copied		

DESIGNED: LALLEN
REVIEWED: KLOWER

Department of State Growth
MIDLAND HIGHWAY (A0087)
ERRING FOREST TO POWANANNA
ROAD IMPROVEMENTS AND SAFETY UPGRADES
DEVELOPMENT APPLICATION
GENERAL ARRANGEMENT - DRG 47 OF 83

CONTRACT No.	2887	DRAWING	16/5/14-12/18	PRINTED DATE	17/Nov/16, 3:58 PM	SHEET No.	249
REGISTRATION NUMBER				A0087.037		REVISION C	



TASMANIA FEEDLOT PTY.
LTD.
LD - 269753
TITLE - 1387037

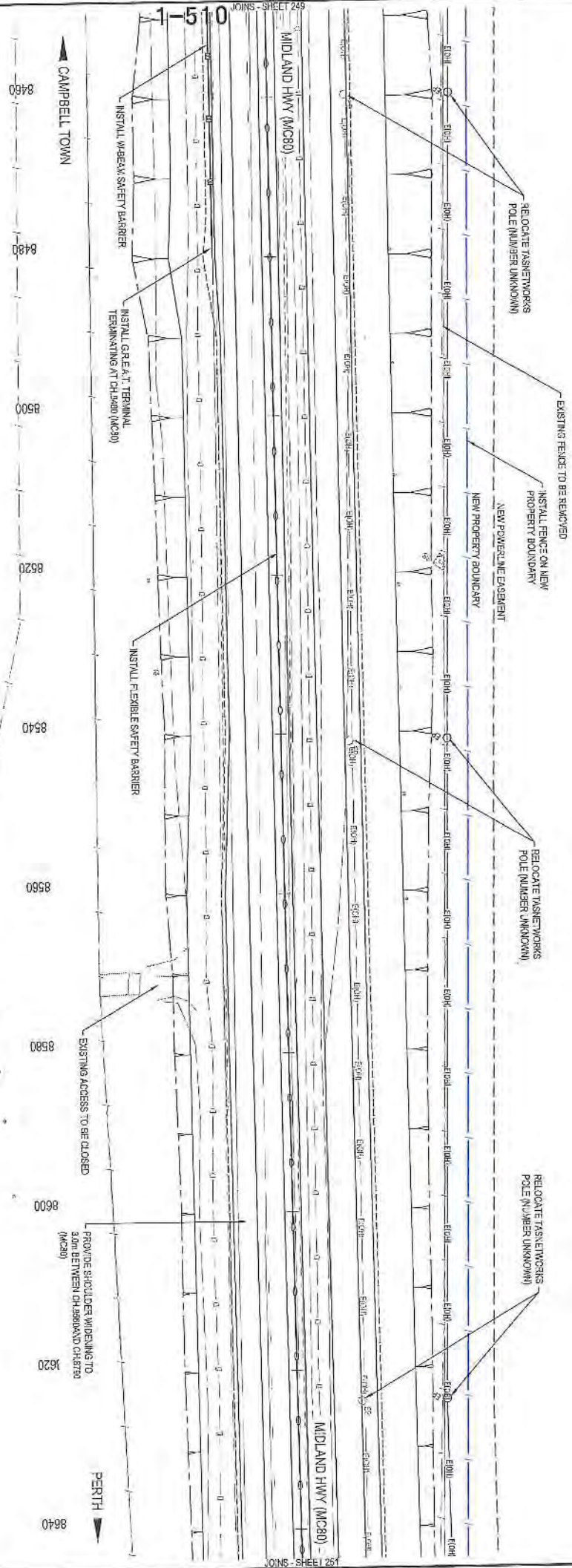

LEGEND	
	PIONEER AVENUE TREES
	PIONEER AVENUE TREES TO BE REMOVED
	THREATENED FLORA
	THREATENED FLORA TO BE REMOVED
	POTENTIAL HABITAT TREE
	HABITAT TREE TO BE REMOVED
	POWRANNA ARTIFACT TO BE PROTECTED
	THREATENED VEGETATION TO BE RETAINED
	PROPOSED PROPERTY FENCELINE

TASMANIA FEEDLOT PTY.
LTD.
LD - 269753
TITLE - 1387037

No.	Amendment Description	Initials	Date
A	PRELIMINARY DESIGN		
B	DEVELOPMENT APPLICATION ISSUE		
C	DEVELOPMENT APPLICATION ISSUE		

SCALES
1:500 (A3)
SCALE RANGES - 1:50

DESIGNED BY: LAUREN
REVIEWED BY: NADWYER

Department of State Growth
MIDLAND HIGHWAY (A0087)
EPPING FOREST TO POWRANNA
ROAD IMPROVEMENTS AND SAFETY UPGRADES
DEVELOPMENT APPLICATION
GENERAL ARRANGEMENT - DRG 48 OF 63

CONTRACT NO. 2387	DRAWING HE16191C260	PRINTED DATE 17 NOV 2016 3:59 PM	SHEET NO. 250
REGISTRATION NUMBERS A0087.037			REVISION C



TASMANIA FERROLOTT PTY.
LTD.
I.D. - 280163
TITLE - 13512302

CAMPBELL TOWN

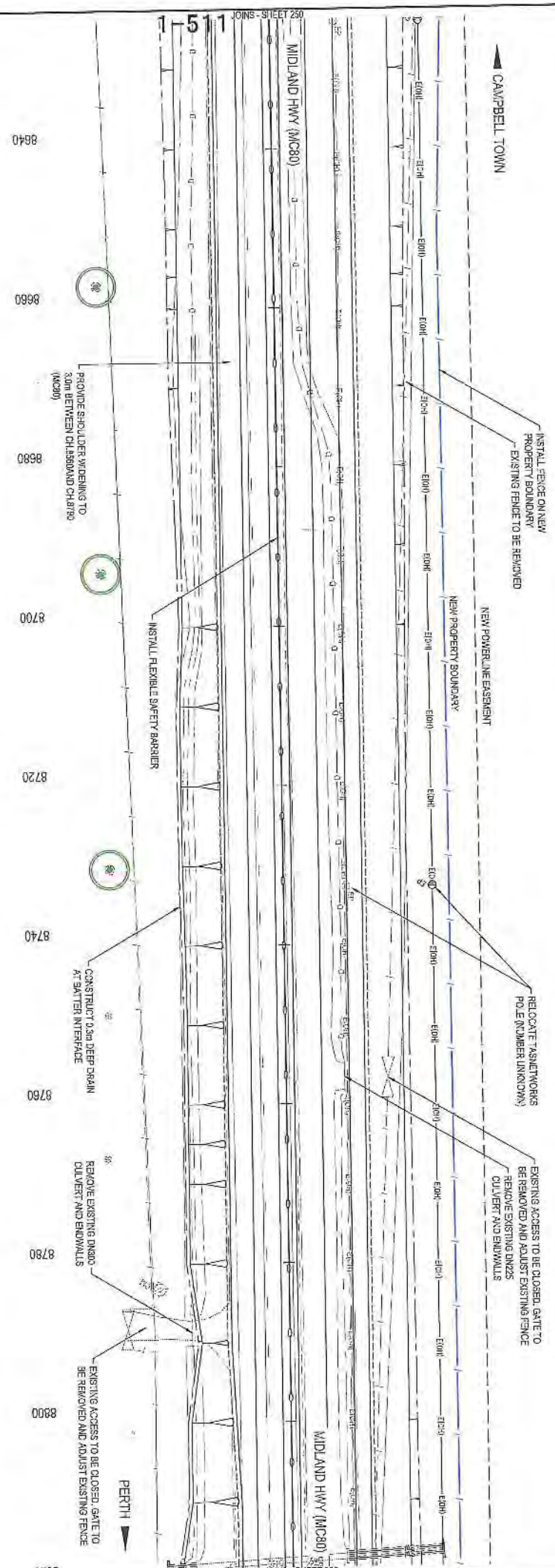

TASMANIA FERROLOTT PTY.
LTD.
I.D. - 280163
TITLE - 13512302

LEGEND	
	PIONEER AVENUE TREES
	PIONEER AVENUE TREES TO BE REMOVED
	THREATENED FLOSA
	THREATENED FLOSA TO BE REMOVED
	POTENTIAL HABITAT TREE
	HABITAT TREE TO BE REMOVED
	POWANNA ARTIFACT TO BE PROTECTED
	THREATENED VEGETATION TO BE RETAINED
	PROPOSED PROPERTY FENCELINE

<p>Department of State Growth</p> <p>MIDLAND HIGHWAY (A0087) EPPING FOREST TO POWRANNA ROAD IMPROVEMENTS AND SAFETY UPGRADES DEVELOPMENT APPLICATION GENERAL ARRANGEMENT - DRG 49 OF 63</p>		<p>CONTRACT NO. 2387</p> <p>DISKING 1616191-C251</p> <p>PRINTED DATE 17 Nov 16, 5:58 PM</p> <p>SHEET No 251</p>																				
<p>DESIGNED LALLEN</p> <p>REVIEWED NADVER</p>	<p>DESIGNED LALLEN</p> <p>REVIEWED NADVER</p>	<p>SCALES</p> <p>1:500 (A3)</p> <p>SCALE IN METRES - 1:500</p>																				
<p>AMENDMENT</p> <table border="1"> <thead> <tr> <th>No.</th> <th>Amendment Description</th> <th>Initials</th> <th>Date</th> </tr> </thead> <tbody> <tr> <td>A</td> <td>PRELIMINARY DESIGN</td> <td>NADVER</td> <td>13/10/2016</td> </tr> <tr> <td>B</td> <td>DEVELOPMENT APPLICATION ISSUE</td> <td>NADVER</td> <td>07/12/2016</td> </tr> <tr> <td>C</td> <td>DEVELOPMENT APPLICATION ISSUE</td> <td>NADVER</td> <td>06/12/2016</td> </tr> <tr> <td>D</td> <td>DEVELOPMENT APPLICATION ISSUE</td> <td>NADVER</td> <td>07/12/2016</td> </tr> </tbody> </table>	No.	Amendment Description	Initials	Date	A	PRELIMINARY DESIGN	NADVER	13/10/2016	B	DEVELOPMENT APPLICATION ISSUE	NADVER	07/12/2016	C	DEVELOPMENT APPLICATION ISSUE	NADVER	06/12/2016	D	DEVELOPMENT APPLICATION ISSUE	NADVER	07/12/2016	<p>AS indicated This sheet may be prepared using colour and may be incomplete if copies</p> <p>Coordinate System: MGA ZONE 55</p> <p>Height Datum: AHD</p>	<p>DESIGNED LALLEN</p> <p>REVIEWED NADVER</p>
No.	Amendment Description	Initials	Date																			
A	PRELIMINARY DESIGN	NADVER	13/10/2016																			
B	DEVELOPMENT APPLICATION ISSUE	NADVER	07/12/2016																			
C	DEVELOPMENT APPLICATION ISSUE	NADVER	06/12/2016																			
D	DEVELOPMENT APPLICATION ISSUE	NADVER	07/12/2016																			



TASMANIA FEED LOT PTY.
LTD.
I.D. - 260165
TITLE - 1951232

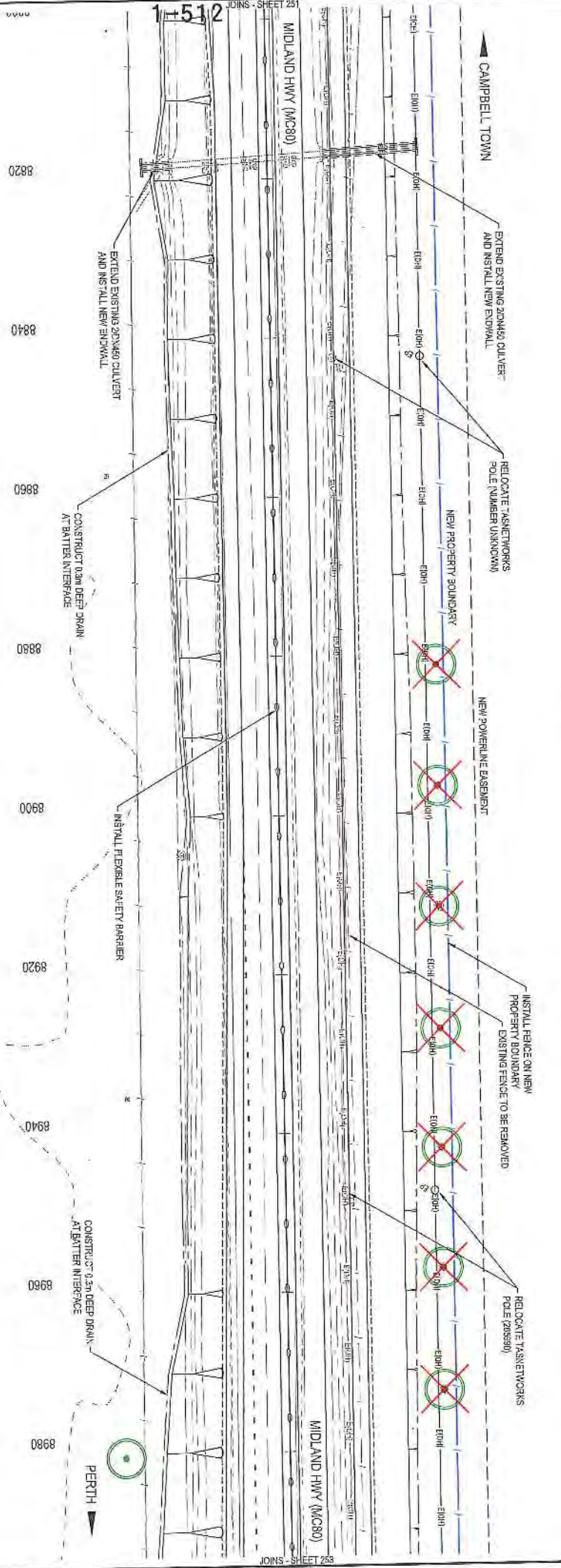

TASMANIA FEED LOT PTY.
LTD.
I.D. - 260165
TITLE - 1951232

LEGEND	
	PIONEER AVENUE TREES
	PIONEER AVENUE TREES TO BE REMOVED
	THREATENED FLORA
	POTENTIAL HABITAT TREE
	HABITAT TREE TO BE REMOVED
	POSSIBLE ARTIFACT TO BE PROTECTED
	THREATENED VEGETATION TO BE RETAINED
	PROPOSED PROPERTY FENCELINE

No.	Amendment Description	Initials	Date
A	PRELIMINARY DESIGN		13/02/2018
B	DEVELOPMENT APPLICATION ISSUE		07/11/2018
C	DEVELOPMENT APPLICATION ISSUE		04/11/2018

SCALES

1:500 (A3)

SCALE HEIGHTS - 1900

Coordinate System: UTM ZONE 58

Map Datum: A.M.D.

DESIGNED BY: LAUREN LALLEY

REVIEWED BY: NADWYER

Department of State Growth

MIDLAND HIGHWAY (A0087)

EPPING FOREST TO POWERRANNA

ROAD IMPROVEMENTS AND SAFETY UPGRADES

DEVELOPMENT APPLICATION

GENERAL ARRANGEMENT - DRG 50 OF 53

CONTRACT NO.	2987	PRINTED DATE	17-Nov-18, 3:55 PM
REGISTRATION NUMBER	A0087.037	SHEET No.	252
DESIGNER	LAUREN LALLEY	REVISION C	



TASMANIA FEEDLOT PTY.
 LTD.
 I.D. - 280183
 TITLE - 1361231

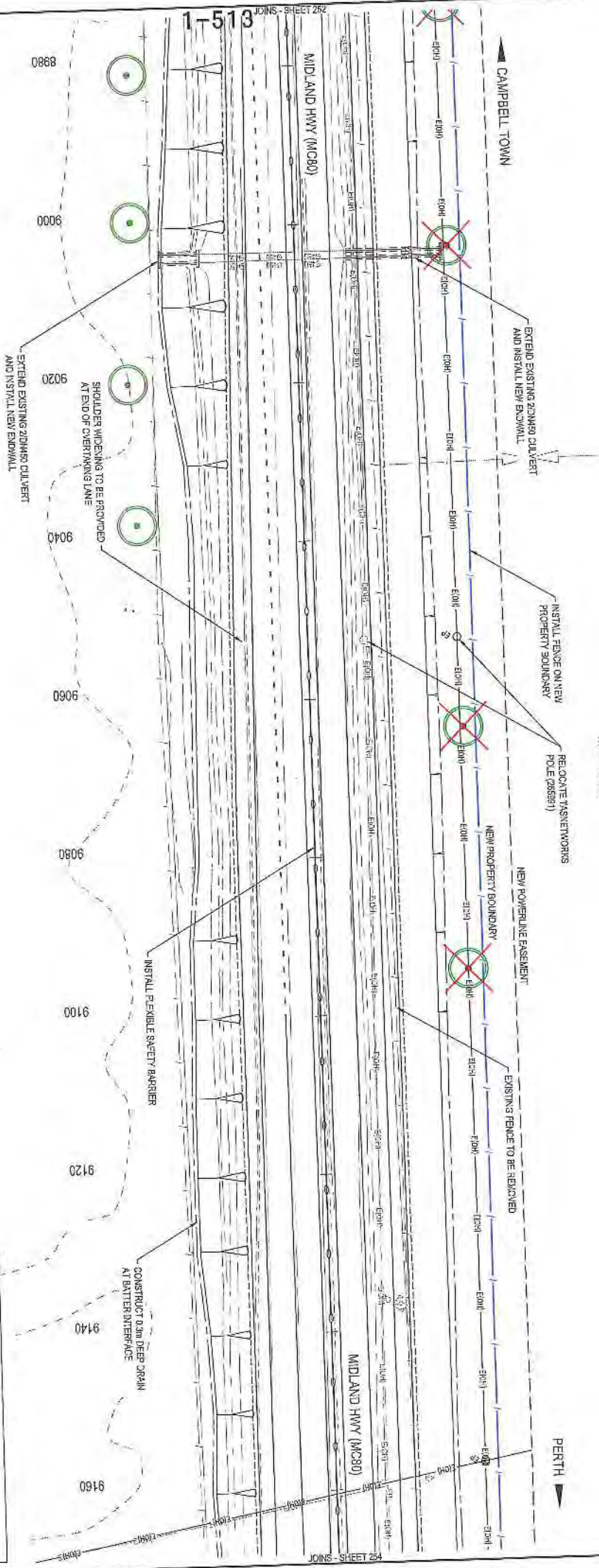

LEGEND	
	PIONEER AVENUE TREES
	PIONEER AVENUE TREES TO BE REMOVED
	THREATENED FLORA
	THREATENED FLORA TO BE REMOVED
	POTENTIAL HABITAT TREE
	HABITAT TREE TO BE REMOVED
	POWANNANA ARTIFACT TO BE PROTECTED
	THREATENED VEGETATION TO BE RETAINED
	PROPOSED PROPERTY FENCE LINE

TASMANIA FEEDLOT PTY.
 LTD.
 I.D. - 280183
 TITLE - 1361231

<p>Department of State Growth</p> <p>MIDLAND HIGHWAY (A0087) ERPPING FOREST TO POWANNANA ROAD IMPROVEMENTS AND SAFETY UPGRADES DEVELOPMENT APPLICATION GENERAL ARRANGEMENT - DRG 51 OF 63</p>		<p>DESIGNED LAUREN NADYVER</p>	<p>REVIEWED NADYVER</p>
<p>CONTRACT NO. 2367</p>	<p>DRAWING HB1619A-C253</p>	<p>PRINTED DATE 17-Nov-16, 3:56 PM</p>	<p>SHEET NO. 253</p>
<p>REGISTRATION NUMBER A0087.037</p>		<p>REVISION C</p>	

<p>NO. 1</p> <p>Amendment Description</p> <p>Date</p>	<p>Initials</p>
<p>NO. 2</p> <p>Amendment Description</p> <p>Date</p>	<p>Initials</p>
<p>NO. 3</p> <p>Amendment Description</p> <p>Date</p>	<p>Initials</p>
<p>NO. 4</p> <p>Amendment Description</p> <p>Date</p>	<p>Initials</p>
<p>NO. 5</p> <p>Amendment Description</p> <p>Date</p>	<p>Initials</p>

As original This sheet may be prepared using cadastre and may be incomplete if applied

SCALES

1:500 (A3)

1" = 5' (1)

SCALE IN METERS - 1:50

1" = 5' (1)

1" = 5' (1)

1" = 5' (1)

1" = 5' (1)

DESIGNED
 LAUREN
 NADYVER

REVIEWED
 NADYVER

Department of State Growth

MIDLAND HIGHWAY (A0087)
 ERPPING FOREST TO POWANNANA
 ROAD IMPROVEMENTS AND SAFETY UPGRADES
 DEVELOPMENT APPLICATION
 GENERAL ARRANGEMENT - DRG 51 OF 63

Department of State Growth

MIDLAND HIGHWAY (A0087)
 ERPPING FOREST TO POWANNANA
 ROAD IMPROVEMENTS AND SAFETY UPGRADES
 DEVELOPMENT APPLICATION
 GENERAL ARRANGEMENT - DRG 51 OF 63

DESIGNED
 LAUREN
 NADYVER

REVIEWED
 NADYVER

CONTRACT NO.
2367

DRAWING
 HB1619A-C253

PRINTED DATE
 17-Nov-16, 3:56 PM

REGISTRATION NUMBER
A0087.037

REVISION C

SHEET NO.
253



TASMANIA FEEDLOT PTY.
LTD.
ID - 260183
TITLE - 20812312

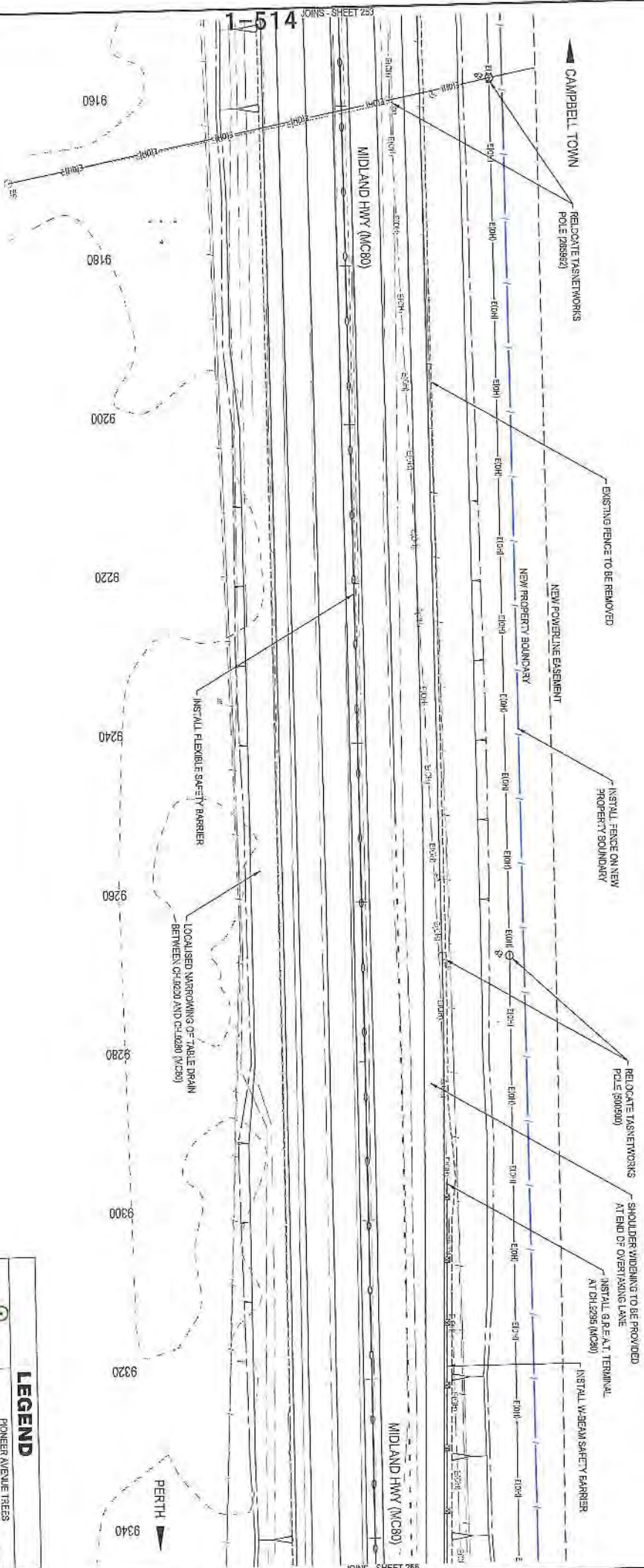

No.	Amendment Description	Revised By	Date
A	PRELIMINARY DESIGN	N.DRYER	23/10/2016
B			
C	DEVELOPMENT APPLICATION ISSUE	N.DRYER	04/11/2016
D	DEVELOPMENT APPLICATION ISSUE	N.DRYER	07/11/2016

SCALES

1:500 (A3)

SCALE IN METRES - 1:500

Coordinate System: MGA ZONE 55

Height Datum: A.M.D.

DESIGNED: LAURIE

REVIEWED: N.DRYER

Department of State Growth

MIDLAND HIGHWAY (A0087)

EPPING FOREST TO POWANNA ROAD IMPROVEMENTS AND SAFETY UPGRADES DEVELOPMENT APPLICATION GENERAL ARRANGEMENT - DRG 52 OF 63

CONTRACT No.	2287	DRAWING	18/11/14-2/254	PRINTED DATE	17/Nov/16, 9:57 PM	SHEET No.	254
REGISTRATION NUMBER	A0087.037					REVISION C	

LEGEND

	PIONEER AVENUE TREES
	PIONEER AVENUE TREES TO BE REMOVED
	THREATENED FLORA
	THREATENED FLORA TO BE REMOVED
	POTENTIAL HABITAT TREE
	HABITAT TREE TO BE REMOVED
	POWANNA ARTIFACT TO BE PROTECTED
	THREATENED VEGETATION TO BE RETAINED
	PROPOSED PROPERTY FENCELINE



TASMANIA FEED LOT PTY.
 LTD.
 I.D. - 280163
 TITLE - 1561292

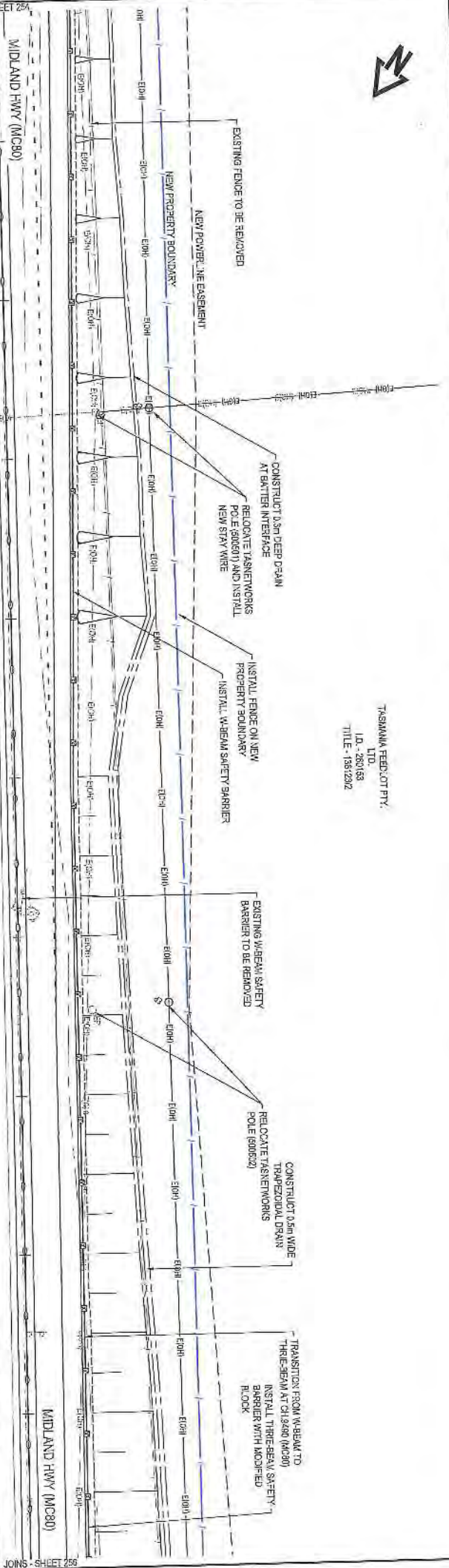

1-515 JOINS SHEET 254



TASMANIA FEED LOT PTY.
 LTD.
 I.D. - 280163
 TITLE - 1561292

LEGEND	
	PIONEER AVENUE TREES
	PIONEER AVENUE TREES TO BE REMOVED
	THREATENED FLORA
	THREATENED FLORA TO BE REMOVED
	CENTRAL HABITAT TREE
	HABITAT TREE TO BE REMOVED
	POWARANKA ARTIFACT TO BE PROTECTED
	THREATENED VEGETATION TO BE RETAINED
	PROPOSED PROPERTY FENCE LINE

No.	Amendment Description	Initials	Date
C	DEVELOPMENT APPLICATION ISSUE	N.D.WYER	04/11/2016
B	DEVELOPMENT APPLICATION ISSUE	N.D.WYER	07/11/2016
A	PRELIMINARY DESIGN	N.D.WYER	13/10/2016

SCALES
 1:500 (A3)
 SCALE NUMBER: 1:500
 Horizontal Datum: A.M.D.

DESIGNED: LALLEN
 REVIEWED: N.D.WYER

Department of State Growth
 MIDLAND HIGHWAY (A0087)
 EPPING FOREST TO POWARANKA
 ROAD IMPROVEMENTS AND SAFETY UPGRADES
 DEVELOPMENT APPLICATION
 GENERAL ARRANGEMENT - DRG 83 OF 83

CONTRACT NO. 2887	DRAWING H91019-0245	PRINTED DATE 17-Nov-16 3:57 PM	SHEET NO. 255
REGISTRATION NUMBER A0087.037			REVISION C

Ad original This sheet may be prepared using colour and may be incomplete if copied



CAMPBELL TOWN

MIDLAND HWY (MC80)

MIDLAND HWY (MC80)

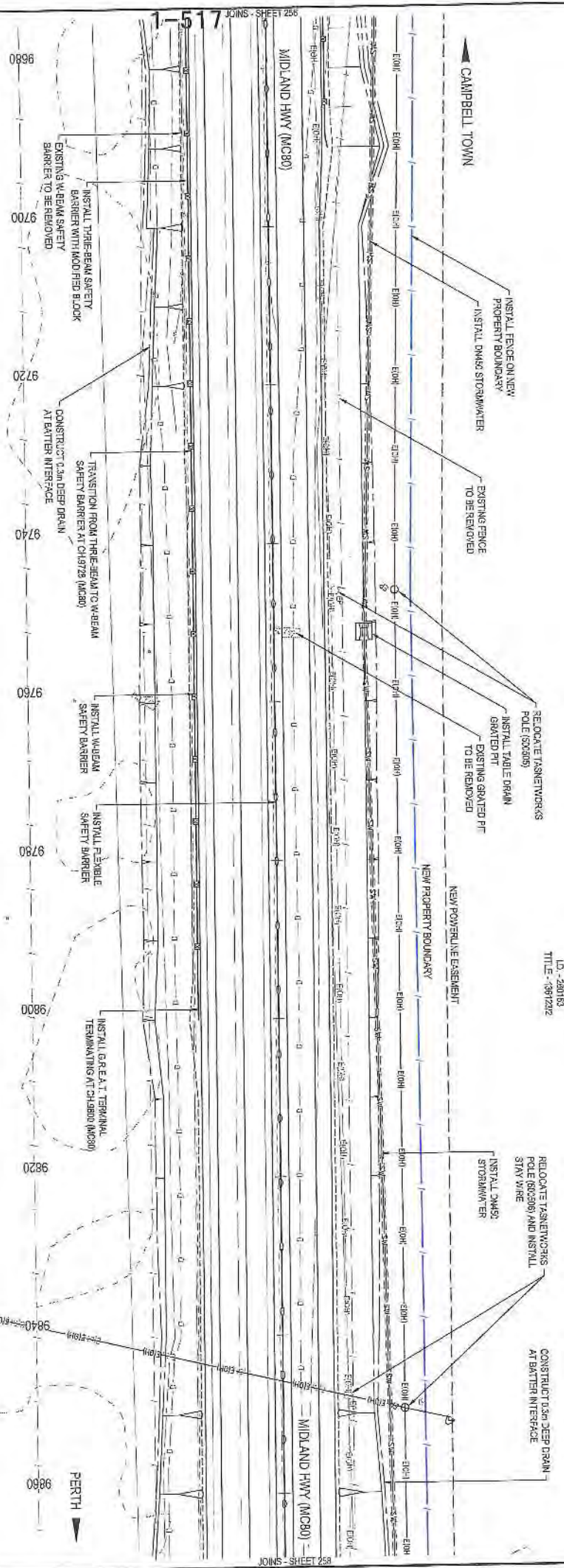

TASMANIA FEEDLOT PTY.
LTD.
LD - 280183
TITLE - '081222

TASMANIA FEEDLOT PTY.
LTD.
LD - 280183
TITLE - '081224

LEGEND	
	PIONEER AVENUE TREES
	PIONEER AVENUE TREES TO BE REMOVED
	THREATENED FLORA
	THREATENED FLORA TO BE REMOVED
	POTENTIAL BIRCH/TREE
	HABITAT TREE TO BE REMOVED
	POWRANNA ARTIFACT TO BE PROTECTED
	THREATENED VEGETATION TO BE RETAINED
	PROPOSED PROPERTY FENCE LINE

<p>Department of State Growth</p> <p>MIDLAND HIGHWAY (A0087)</p> <p>EPPING FOREST TO POWRANNA ROAD IMPROVEMENTS AND SAFETY UPGRADES DEVELOPMENT APPLICATION</p> <p>GENERAL ARRANGEMENT - DRG 55 OF 63</p>		<p>CONTRACT No. 2567</p> <p>CRANKING HR/191/1287</p> <p>PRINTED DATE 17-Nov-18, 9:57 PM</p>	<p>SHEET No. 257</p> <p>REVISION C</p>
<p>NO. 1</p> <p>DESCRIPTION</p> <p>DATE</p>	<p>NO. 1</p> <p>DESCRIPTION</p> <p>DATE</p>	<p>DESIGNED L. ALLEN</p> <p>REVIEWED N. DWYER</p>	
<p>A PRELIMINARY DESIGN</p> <p>B DEVELOPMENT APP. CATALOGUE ISSUE</p> <p>C DEVELOPMENT APPLICATION ISSUE</p>	<p>A PRELIMINARY DESIGN</p> <p>B DEVELOPMENT APP. CATALOGUE ISSUE</p> <p>C DEVELOPMENT APPLICATION ISSUE</p>	<p>SCALES</p> <p>1:500 (AS)</p> <p>SCALE HEREIN - 500</p>	
<p>As of/for: This sheet may be prepared using colour and may be reproduced if copied</p>		<p>Perth</p>	



TASKAMA FEEDLOT PTY.
 LTD.
 LD - 2881839
 TITLE - 186192/2

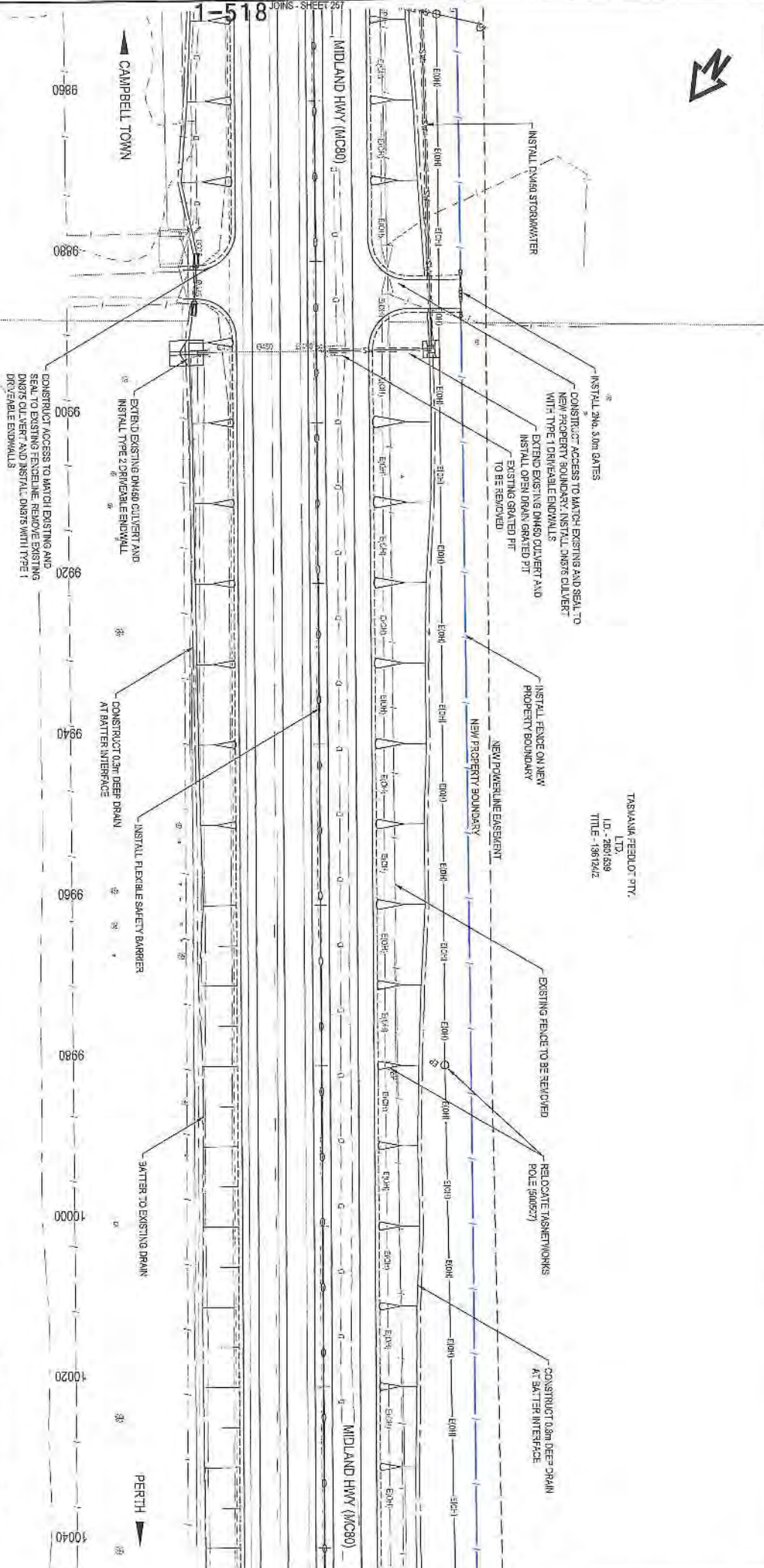

TASKAMA FEEDLOT PTY.
 LTD.
 LD - 2881839
 TITLE - 186192/2

LEGEND	
	PIONEER AVENUE TREES
	PIONEER AVENUE TREES TO BE REMOVED
	THREATENED FLORA
	THREATENED FLORA TO BE REMOVED
	POTENTIAL HABITAT TREE
	HABITAT TREE TO BE REMOVED
	POKORANNA ARTIFACT TO BE PROTECTED
	THREATENED VEGETATION TO BE REMOVED
	PROPOSED PROPERTY FENCELINE

Department of State Growth MIDLAND HIGHWAY (A0087) EPPING FORESTS TO POWRANNA ROAD IMPROVEMENTS AND SAFETY UPGRADES DEVELOPMENT APPLICATION GENERAL ARRANGEMENT - DRG 66 OF 63		CONTRACT NO. 2387	DRAWINGS H818191-0268	PRINTED DATE 7/26/2016 3:57 PM	SHEET No. 258
SCALES 1:500 (A3) SCALE BARRIES - 1:500		DESIGNED L. ALLEN	REVIEWED N. DYWES	REGISTRATION NUMBER A0087.037	
DEVELOPMENT APPLICATION ISSUE N. DYWES 04/11/2016		DEVELOPMENT APPLICATION ISSUE N. DYWES 01/11/2016		REVISION C	
PRELIMINARY DESIGN N. DYWES 13/10/2016		PRELIMINARY DESIGN N. DYWES 13/10/2016		REVISION C	
Amendment Description Initials Date		Amendment Description Initials Date		REVISION C	
This sheet may be prepared using color and may be inspected if special		This sheet may be prepared using color and may be inspected if special		REVISION C	

1-518 JOINS - SHEET 257

JOINS - SHEET 259



TASMANIA FENCELOT P.T.Y.
LTD.
I.D. - 2621638
TTL-E - 38124/2

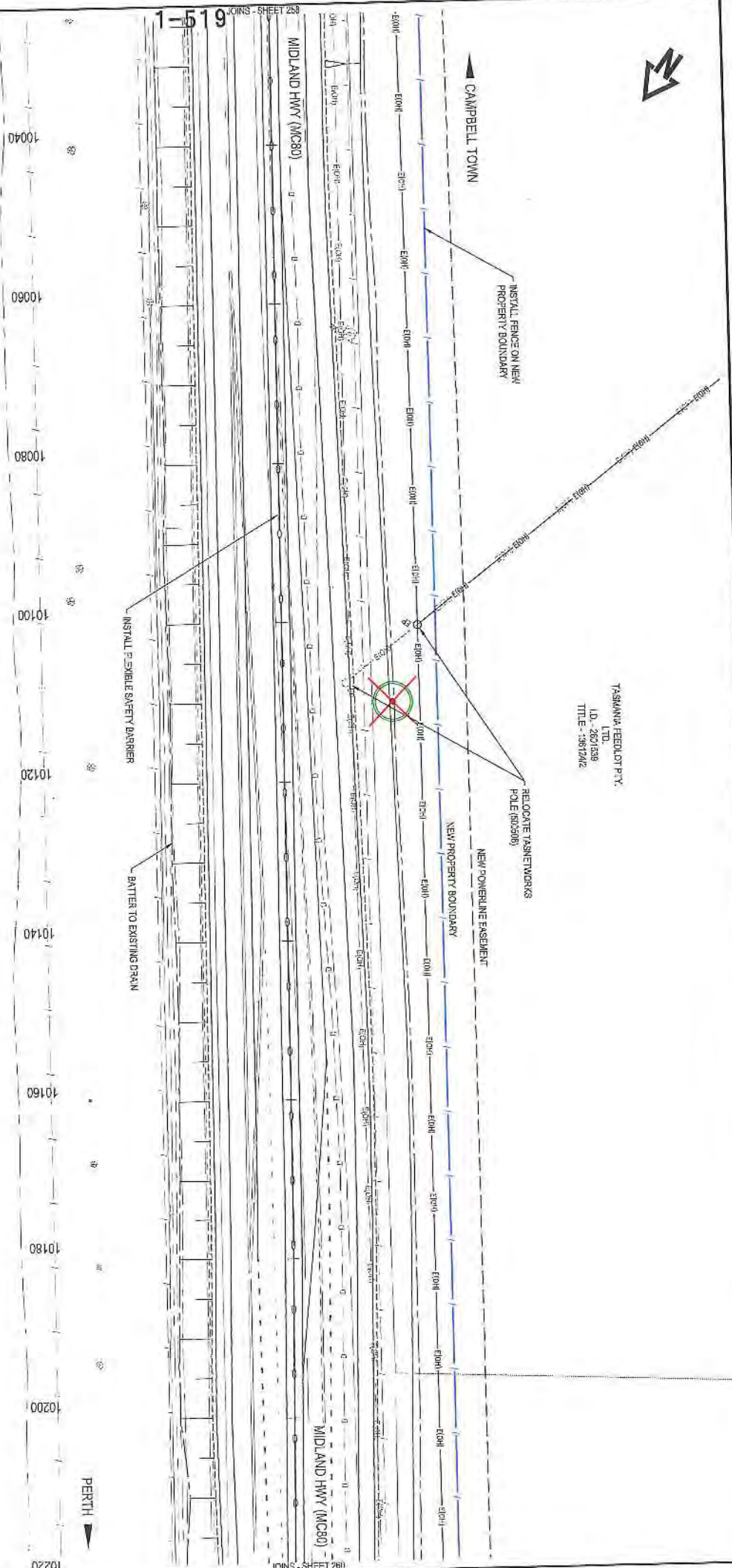

TASMANIA FENCELOT P.T.Y.
LTD.
I.D. - 2621638
TTL-E - 38124/2

LEGEND	
	PIONEER AVENUE TREES
	PIONEER AVENUE TREES TO BE REMOVED
	THREATENED FLORA
	THREATENED FLORA TO BE REMOVED
	POTENTIAL HABITAT TREE
	HABITAT TREE TO BE REMOVED
	POWRANNA ARTIFACT TO BE PROTECTED
	THREATENED VEGETATION TO BE REMOVED
	PROPOSED PROPERTY FENCELINE

<p>Department of State Growth</p> <p>MIDLAND HIGHWAY (A0087)</p> <p>ERRING FORESTS TO POWRANNA</p> <p>ROAD IMPROVEMENTS AND SAFETY UPGRADES</p> <p>DEVELOPMENT APPLICATION</p> <p>GENERAL ARRANGEMENT - DRG 57 OF 63</p>		<p>CONTRACT NO.</p> <p>2567</p>	<p>DRAWING</p> <p>REGISTRATION NUMBER</p> <p>A0087.037</p>	<p>PRINTED DATE</p> <p>17/Nov/16, 9:57 PM</p>	<p>SHEET NO.</p> <p>259</p>
<p>DESIGNED</p> <p>LALLEN</p>	<p>REVIEWED</p> <p>N.DWYER</p>	<p>Department of State Growth</p> <p>1:500 (A3)</p> <p>SCALE RIFTERS - 1:50</p>			
<p>DEVELOPMENT APPLICATION ISSUE</p> <p>N.DWYER 04/11/2016</p>	<p>DEVELOPMENT APPLICATION ISSUE</p> <p>N.DWYER 01/11/2016</p>	<p>SCALES</p> <p>1:500 (A3)</p> <p>SCALE RIFTERS - 1:50</p>			
<p>PRELIMINARY DESIGN</p> <p>N.DWYER 13/10/2016</p>	<p>Amendment Description</p> <p>Initials</p> <p>Date</p>	<p>Amendment Description</p> <p>Initials</p> <p>Date</p>			
<p>This sheet may be prepared using colour and may be incomplete if copied</p>					



T. STRICKLAND
L.D. - 280185
TITLE - 152065

THE CROWN
TITLE - 123384

TASMANIA FEEDLOT PTY.
LTD.
L.D. - 2801533
TITLE - 1961281

CAMPBELL TOWN

EXISTING FENCE
TO BE REMOVED

RELOCATE TASNETWORKS
POLE (600509)

NEW POWERLINE ESSENT

NEW PROPERTY BOUNDARY

INSTALL FENCE ON NEW
PROPERTY BOUNDARY

INSTALL DRAINAGE CULVERT
WITH PILEM ENDWALLS
REMOVE EXISTING DRAIN
CULVERT AND ENDWALLS

RELOCATE TASNETWORKS
POLE (602510)

PERTH

MIDLAND HWY (MC80)

MIDLAND HWY (MC80)

1-520

10220

10240

10260

10280

10300

10320

10340

10360

10380

INSTALL FLEXIBLE SAFETY BARRIER

BATTER TO EXISTING DRAIN

INSTALL FLEXIBLE SAFETY BARRIER
ANCHOR BLOCK AT CH. 10360 (MC20)

CONSTRUCT ACCESS TO MATCH
EXISTING AND ASPHALT TO
MATCH IN POINT

TASMANIA FEEDLOT PTY.
LTD.
L.D. - 280183
TITLE - 1154522

TASMANIA FEEDLOT PTY.
LTD.
L.D. - 2801804
TITLE - 1873961

TASMANIA FEEDLOT PTY.
LTD.
L.D. - 2801539
TITLE - 1402714

LEGEND

	PIONEER AVENUE TREES
	PIONEER AVENUE TREES TO BE REMOVED
	THREATENED FLORA
	THREATENED FLORA TO BE REMOVED
	POTENTIAL HABITAT TREE
	HABITAT TREE TO BE REMOVED
	POMANNA ARTIFACT TO BE PROTECTED
	THREATENED VEGETATION TO BE RETAINED
	PROPOSED PROPERTY BOUNDARY

SCALES

1:500 (A3)



SCALE IN METERS: 1:500

DESIGNED

LALLEN

REVIEWED

N. DRYER

Department of State Growth

MIDLAND HIGHWAY (A0087)
EPPING FOREST TO POMANNA
ROAD IMPROVEMENTS AND SAFETY UPGRADES
DEVELOPMENT APPLICATION
GENERAL ARRANGEMENT - DRG 58 OF 63

CONTRACT No.

2397

DRAWING

HE 5191-C260

PRINTED DATE

17-Nov-16 3:57 PM

SHEET No.

260

REGISTRATION NUMBER

A0087.037

REVISION

C

A3 original This sheet may be printed using colour and may be incomplete if copied

Geographical System: MGA ZONE 55

Height Datum: A.H.D.

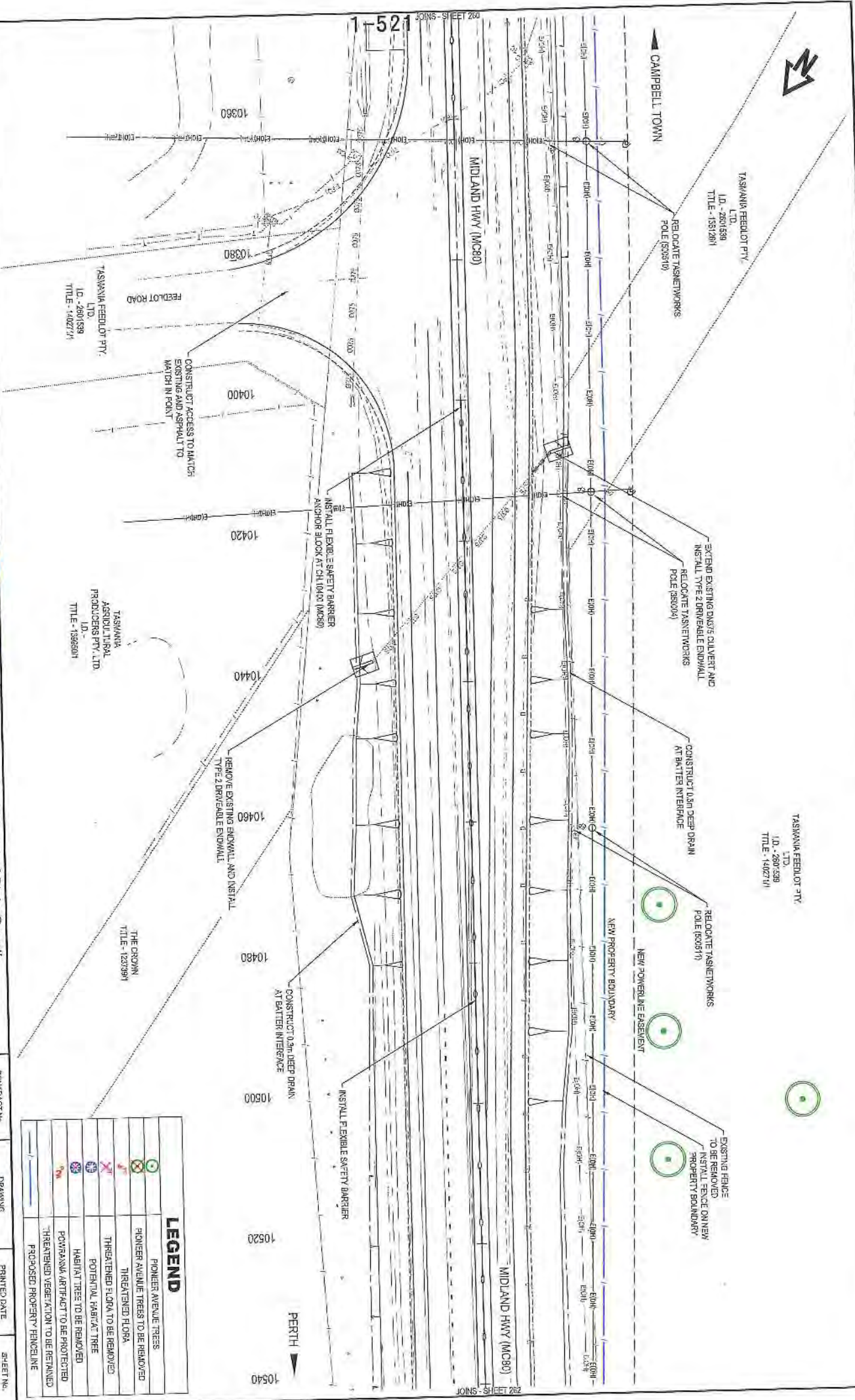

TASMANIA FEEDLOT PTY.
LTD.
I.D. - 2681539
TITLE - 1531281

TASMANIA FEEDLOT PTY.
LTD.
I.D. - 2681539
TITLE - 1531281

TASMANIA FEEDLOT PTY.
LTD.
I.D. - 2681539
TITLE - 1402774

THE CROWN
TITLE - 1237991

TASMANIA
AGRI-CULTURAL
PRODUCERS PTY. LTD.
I.D. -
TITLE - 13965001

LEGEND	
	PIONEER AVENUE TREES
	PIONEER AVENUE TREES TO BE REMOVED
	THREATENED FLORA
	THREATENED FLORA TO BE REMOVED
	POTENTIAL HABITAT TREE
	HABITAT TREES TO BE REMOVED
	POVRANKA ARTIFACT TO BE PROTECTED
	THREATENED VEGETATION TO BE RETAINED
	PROPOSED PROPERTY FENCELINE

SCALES
1:500 (A3)
SCALE 1:500 - 1:500



DESIGNED BY: LALEX
CHECKED BY: NADWYER

Department of State Growth
MIDLAND HIGHWAY (A0087)
EPPING FOREST TO POMORANNA
ROAD IMPROVEMENTS AND SAFETY UPGRADES
DEVELOPMENT APPLICATION
GENERAL ARRANGEMENT - DRG 59 OF 63

No.	Amendment Description	Initials	Date
A	PRELIMINARY DESIGN		
B	DEVELOPMENT APPLICATION ISSUE		
C	DEVELOPMENT APPLICATION ISSUE		
D	DEVELOPMENT APPLICATION ISSUE		
As original			

CONTRACT No. 2887

DRAWING No. HE1914261

PRINTED DATE 17 Nov '15, 3:57 PM

SHEET No. 261

REGISTRATION NUMBER A0087.037

REVISION C



TASMANIA FEEDLOT PTY.
LTD.
LD - 2604538
TITLE - 1402711

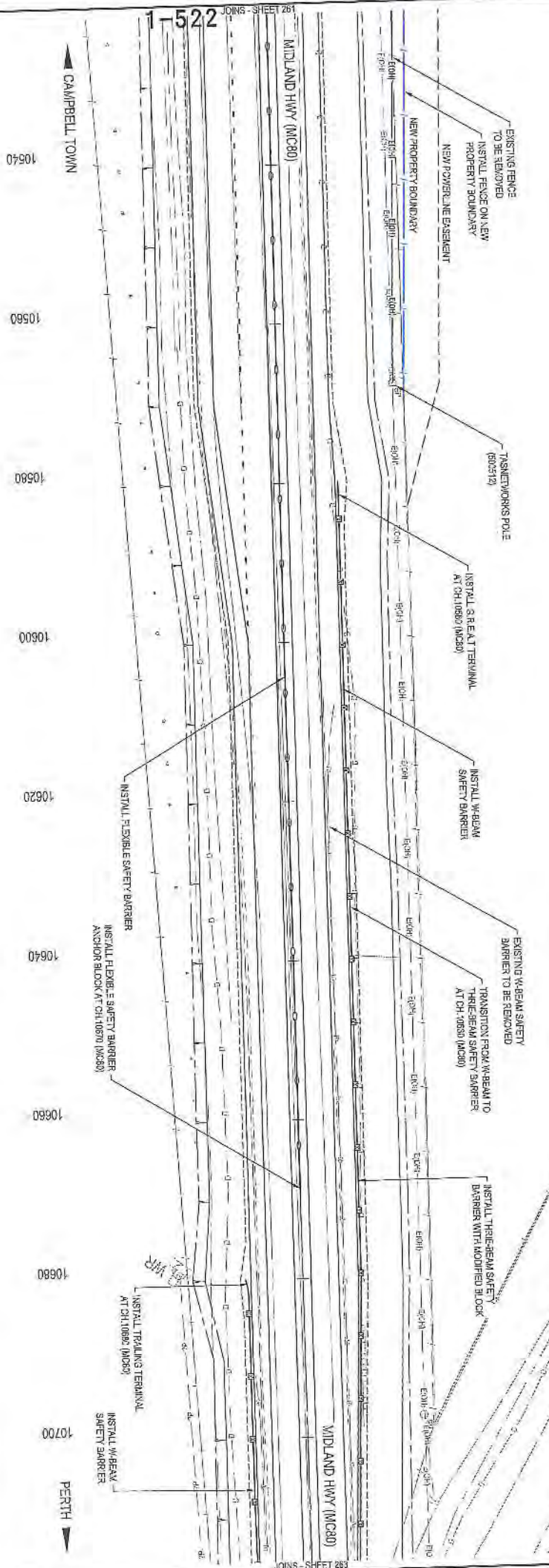

TASMANIA FEEDLOT PTY.
LTD.
LD - 2604538
TITLE - 1402711

LEGEND	
	PICKER AVENUE TREES
	PIONEER AVENUE TREES TO BE REMOVED
	THREATENED FLORA
	THREATENED FLORA TO BE REMOVED
	POTENTIAL HABITAT TREE
	HABITAT TREE TO BE REMOVED
	TASMANIAN ARTIFACT TO BE PROTECTED
	THREATENED VEGETATION TO BE RETAINED
	PROPOSED PROPERTY FENCELINE

<p>Department of State Growth</p> <p>MIDLAND HIGHWAY (A0087) EPPING FOREST TO POWANNA ROAD IMPROVEMENTS AND SAFETY UPGRADES DEVELOPMENT APPLICATION GENERAL ARRANGEMENT - DRG 60 OF 63</p>		<p>CONTRACT NO. 2567</p> <p>DRAWING H816191-C282</p> <p>PRINTED DATE 17-Nov-16 3:58 PM</p> <p>SHEET NO. 262</p>
<p>DESIGNED LALLEN</p> <p>REVIEWED NDUYER</p>	<p>SCALES 1:500 (A3) SCALE RATIO: 1:500</p> <p>Height Datum: A.H.D.</p>	<p>REGISTRATION NUMBER A0087.037</p> <p>REVISION C</p>
<p>NO. 1</p> <p>Amendment Description:</p> <p>Initial: NDUYER</p> <p>Date: 13/10/2016</p>	<p>NO. 2</p> <p>Amendment Description:</p> <p>Initial: NDUYER</p> <p>Date: 13/10/2016</p>	<p>NO. 3</p> <p>Amendment Description:</p> <p>Initial: NDUYER</p> <p>Date: 13/10/2016</p>
<p>23 of 23</p> <p>This sheet may be prepared using colour and may be incomplete if copied</p>		



TASMANIA FEEDLOT PTY.
 LTD.
 I.D. - 2801839
 TITLE - 1402714

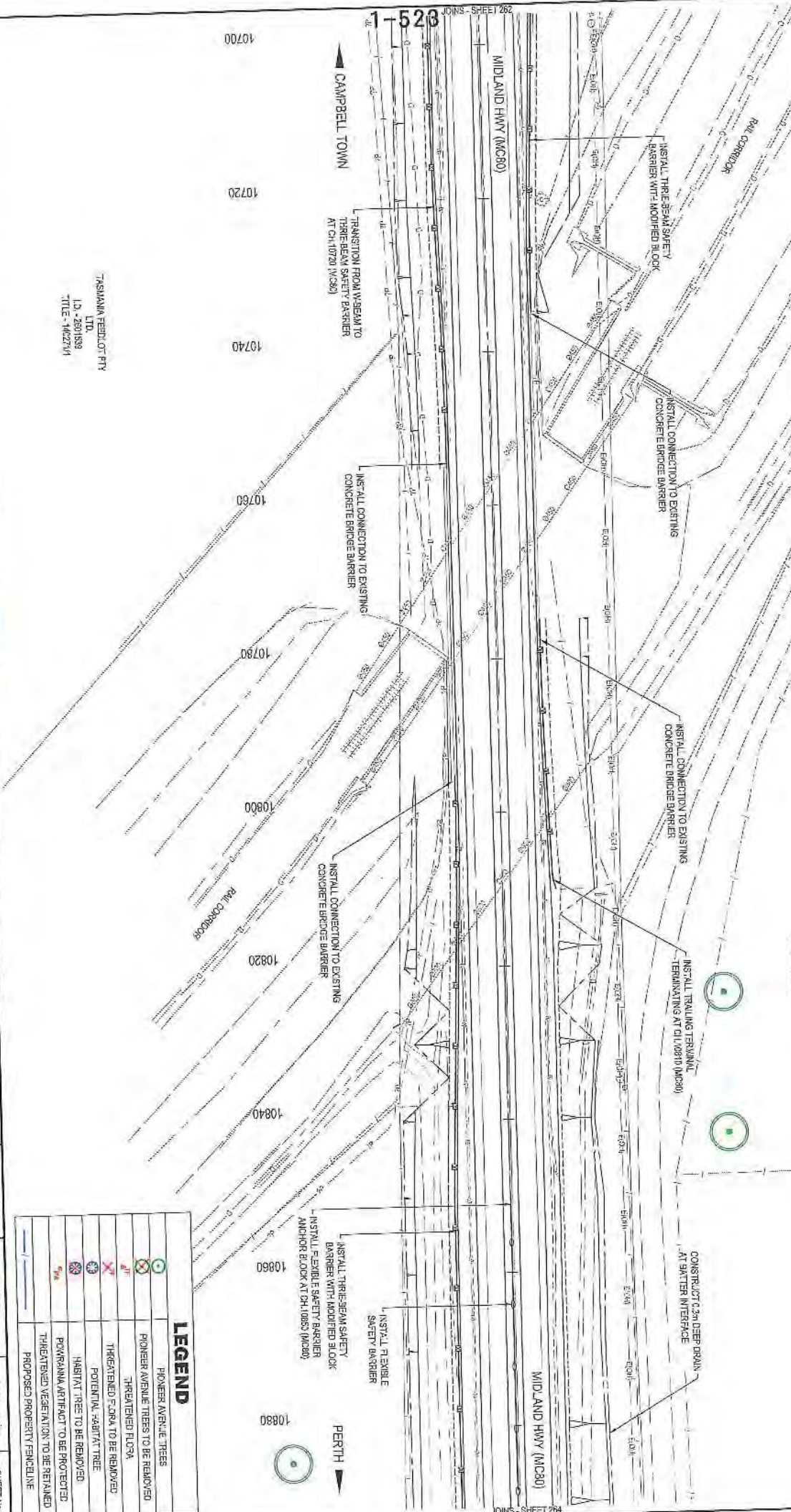

TASMANIA FEEDLOT PTY.
 LTD.
 I.D. - 2801839
 TITLE - 1402714

LEGEND	
	PIONEER AVENUE TREES
	PIONEER AVENUE TREES TO BE REMOVED
	THREATENED FLORA
	THREATENED FLORA TO BE REMOVED
	POTENTIAL HABITAT TREE
	HABITAT TREE TO BE REMOVED
	POWANNA ARTIFACT TO BE PROTECTED
	THREATENED VEGETATION TO BE RETAINED
	PROPOSED PROPERTY FENCELINE

<p>Department of State Growth</p> <p>MIDLAND HIGHWAY (A0087)</p> <p>EPPING FOREST TO POWANNA</p> <p>ROAD IMPROVEMENTS AND SAFETY UPGRADES</p> <p>DEVELOPMENT APPLICATION</p> <p>GENERAL ARRANGEMENT - DRG 61 OF 63</p>		<p>CONTRACT No.</p> <p>2867</p>	<p>DRAWING</p> <p>HB 16191-C263</p>	<p>PRINTED DATE</p> <p>TU Nov 16, 3:58 PM</p>	<p>SHEET No.</p> <p>263</p>
<p>DESIGNED</p> <p>LALLEN</p>		<p>REGISTERED NUMBER</p> <p>A0087.037</p>		<p>REVISION C</p>	
<p>REVIEWED</p> <p>NDWYER</p>		<p>SCALES</p> <p>1:500 (A3)</p> <p>SCALE NUMBER - 300</p>		<p>REVISION D</p>	
<p>NO.</p> <p>1</p>		<p>Amendment Description:</p> <p>Initial</p> <p>Date</p>		<p>AS original</p> <p>This sheet may be proposed using colour and may be incomplete if copied</p>	



TASMANIA FEROLO PTY.
LTD.
ID - 2801539
TITLE - 14027/1

NOTE:
POTENTIAL HABITAT TREE TO BE REMOVED IN
ACCORDANCE WITH SPECIFICATION AND IN
PRESENCE OF DEPARTMENT APPROVED
ECOLOGIST

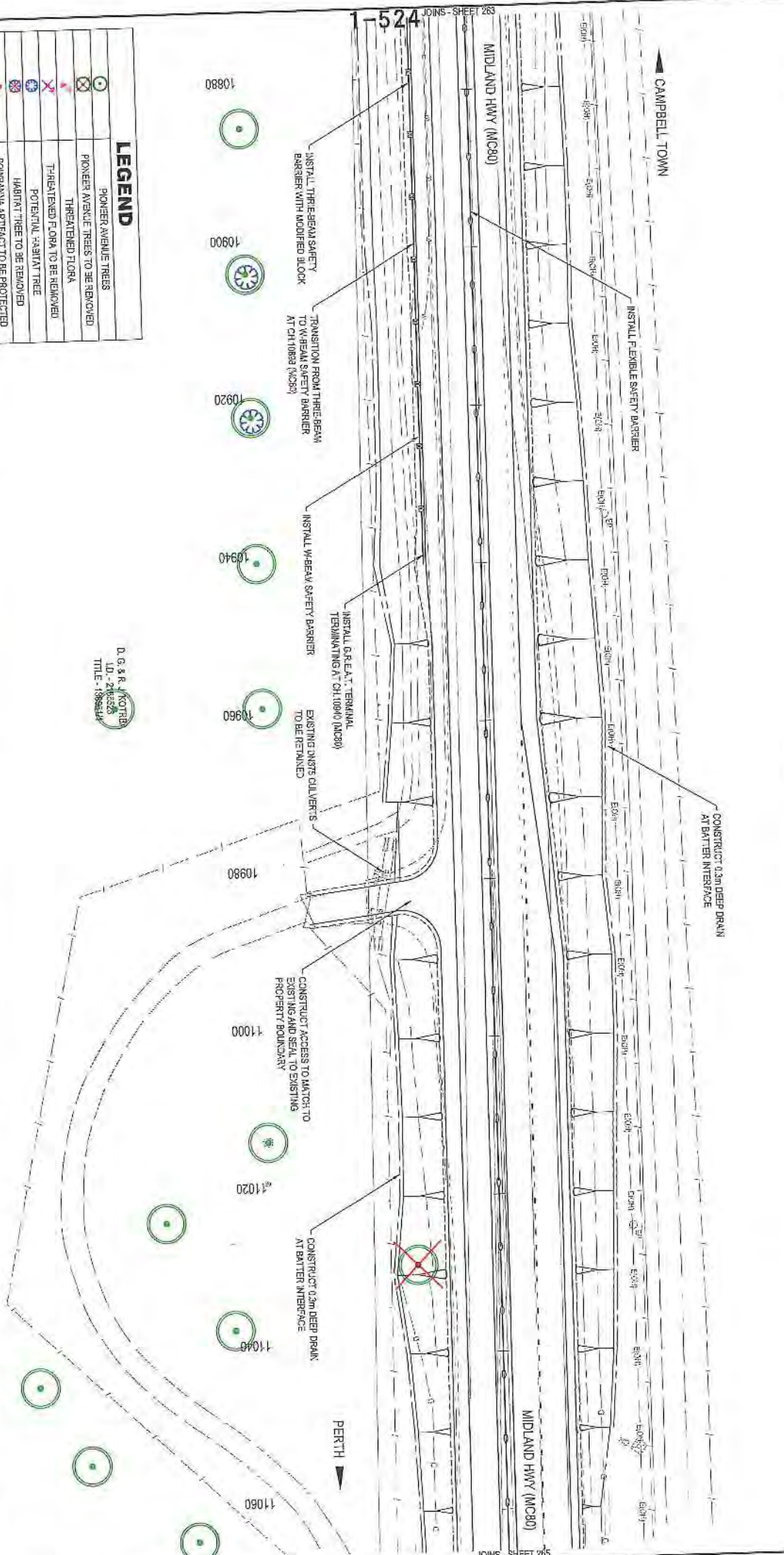

LEGEND	
	PIONEER AVENUE TREES
	PIONEER AVENUE TREES TO BE REMOVED
	THREATENED FLORA
	THREATENED FLORA TO BE REMOVED
	POTENTIAL MAINT TREE
	HABITAT TREE TO BE REMOVED
	POWRANNA ATTRACT TO BE PROTECTED
	THREATENED VEGETATION TO BE RETAINED
	PROPOSED PROPERTY FENCELINE

D. G. S.R. KNOTER
L.D. - 21832/6
TITLE - 18854/1

No.	Amendment Description	Initials	Date
A	PRELIMINARY DESIGN		
B	DEVELOPMENT APPLICATION ISSUE		
C	DEVELOPMENT APPLICATION ISSUE		
D	DEVELOPMENT APPLICATION ISSUE		

SCALES	
1:500 (A3)	
SCALE IN METRES - 1:500	

DESIGNED	LAULEN
REVIEWED	N.DWYER

Department of State Growth
MIDLAND HIGHWAY (A0087)
ERING FOREST TO POWRANNA
ROAD IMPROVEMENTS AND SAFETY UPGRADES
DEVELOPMENT APPLICATION
GENERAL ARRANGEMENT - DRG 82 OF 63

CONTRACT NO.	2567	DRAWING	H81913-C264	PRINTED DATE	17-12-2016 3:58 PM	SHEET NO.	264
REGISTRATION NUMBER	A0087.037	REVISION	C				

AD original This sheet may be prepared using eDraw and may be incomplete if copied



JOINS - SHEET 270

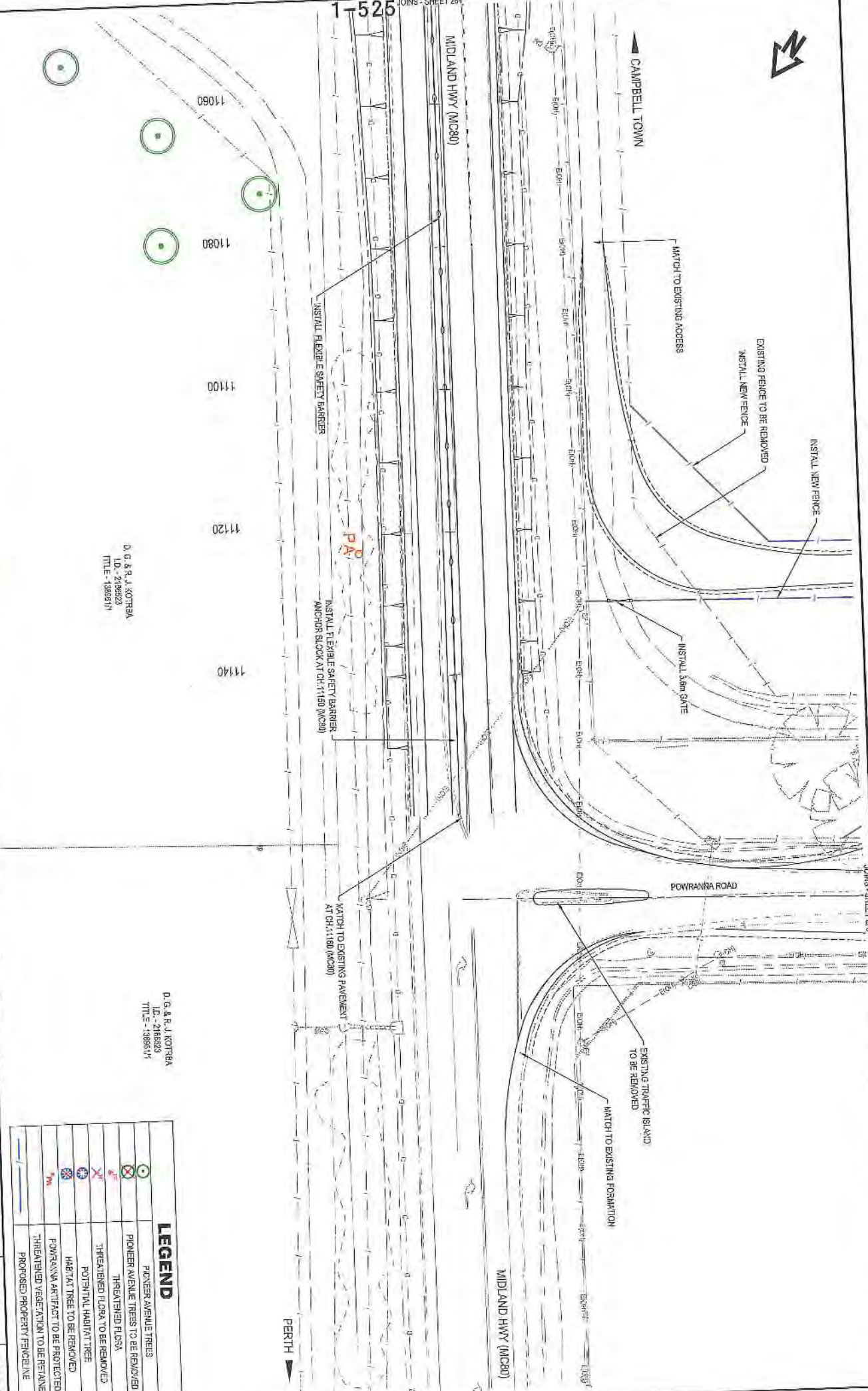

1-525 JOINS - SHEET 264

D. G. & R. J. KOTRBA
 I.D. - 2186823
 TITLE - 18985/11

D. G. & R. J. KOTRBA
 I.D. - 2186823
 TITLE - 18985/11

LEGEND	
	PIONEER AVENUE TREES
	PIONEER AVENUE TREES TO BE REMOVED
	THREATENED FLOSA
	THREATENED FLORA TO BE REMOVED
	POTENTIAL HABITAT TREE
	HABITAT TREE TO BE REMOVED
	POWRANNA ARTIFACT TO BE PROTECTED
	THREATENED VEGETATION TO BE REMOVED
	PROPOSED PROPERTY FENCELINE

No.	Amendment Description	Initials	Date
A	PRELIMINARY DESIGN		
B	DEVELOPMENT APPLICATION ISSUE		
C	DEVELOPMENT APPLICATION ISSUE		
D	UNPUBLISHED JOINS SHEET NUMBER		

SCALES
 1:500 (A3)
 SCALE HORIZONTALS - 1:500

CONDATE SYSTEM: MGA ZONE 55
 HEIGHT DATUM: A.M.D.

DESIGNED BY: LALLEN
 REVIEWED BY: NADWYER

Department of State Growth
 Government of Western Australia

Department of State Growth
 MIDLAND HIGHWAY (A0087)
 EPPING FORESTS AND SAFETY UPGRADES
 ROAD IMPROVEMENTS AND SAFETY UPGRADES
 DEVELOPMENT APPLICATION
 GENERAL ARRANGEMENT - DRG 63 OF 63

CONTRACT No. 2987	DRAWING H181519-C298	PRINTED DATE 17-Nov-26, 8:58 PM	SHEET No. 265
REGISTRATION NUMBER A0087.037		REVISION D	



1-526

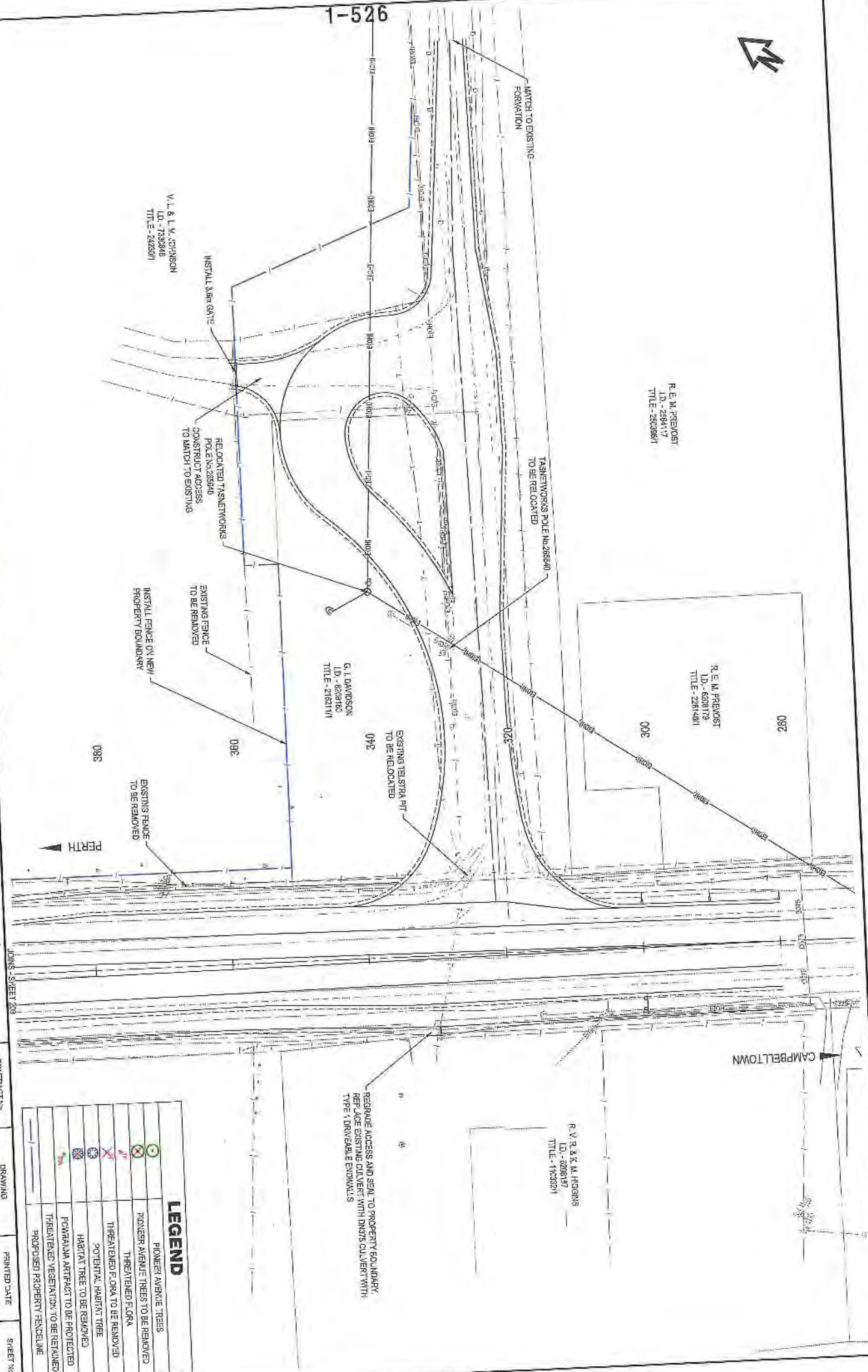

R. E. M. PREVOST
I.D. - 2564117
TITLE - 2832861

R. E. M. PREVOST
I.D. - 6208173
TITLE - 2291481

G. I. DAVIDSON
I.D. - 6208162
TITLE - 2162111

R. V. R. & M. HIGGINS
I.D. - 6208157
TITLE - 1103224

V. L. & L. M. JOHNSON
I.D. - 7302816
TITLE - 2422071

No.	Attachment Description	Initials	Date
A	PRELIMINARY DESIGN		
B	DEVELOPMENT APPLICATION ISSUE		
C	DEVELOPMENT APPLICATION ISSUE		
D	PRELIMINARY DESIGN		

SCALES
1:500 (A3)
SCALE: 1:500
SCALE: 1:500

Coordinate System: MGA ZONE 55
Height datum: AGLD

DESIGNED: L. ALLEN
REVIEWED: N. DWYER

Department of State Growth
MIDLAND HIGHWAY (A0087)
EPPING FOREST TO POWRANNA
ROAD IMPROVEMENTS AND SAFETY UPGRADES
DEVELOPMENT APPLICATION
JUNCTION DETAILS - DRG 1 OF 5

CONTRACT NO. 2987	DRAWING HR/19/1-2288	PRINTED DATE 17/04/16, 3:58 PM	SHEET NO. 266
REGISTRATION NUMBER A0087.037			REVISION D

LEGEND	
	PIONEER AVENUE TREES
	PIONEER AVENUE TREES TO BE REMOVED
	THREATENED FLORA
	THREATENED FLORA TO BE REMOVED
	POTENTIAL HABITAT TREE
	HABITAT TREE TO BE REMOVED
	POWRANNA ARTIFACT TO BE PROTECTED
	THREATENED VEGETATION TO BE REMOVED
	PROPOSED PROPERTY FENCELINE

1-527



Amendment Description	
A	PRELIMINARY DESIGN
B	DEVELOPMENT APPLICATION ISSUE
C	DEVELOPMENT APPLICATION ISSUE
No. Amendment Description	
No.	This sheet may be prepared using colour and may be interpreted if needed

SCALES
1:500 (A3)
SCALE HERE: 1:500

DESIGNED BY: LALUY
REVIEWED BY: NADWYER

Department of State Growth
MIDLAND HIGHWAY (A0087)
ERRING FOREST TO POWANNA
ROAD IMPROVEMENTS AND SAFETY UPGRADES
DEVELOPMENT APPLICATION
JUNCTION DETAILS - DRG 2 OF 5

CONTRACT No. 2387	DRAWING HP/191-0287	PRINTED DATE 17-Nov-16, 5:59 PM	SHEET No. 267
REGISTRATION NUMBER A0087.037		REVISION C	

LEGEND	
	PIONEER AVENUE TREES
	THREATENED FLORA
	THREATENED FLORA TO BE REMOVED
	POTENTIAL HABITAT TREE
	HABITAT TREE TO BE REMOVED
	POWANNA ARTIFACT TO BE PROTECTED
	THREATENED VEGETATION TO BE RETAINED
	PROPOSED PROPERTY FENCELINE



LEGEND

	PIONEER AVENUE TREES
	PIONEER AVENUE TREES TO BE REMOVED
	THREATENED FLORA
	THREATENED FLORA TO BE REMOVED
	POTENTIAL HABITAT TREE
	HABITAT TREE TO BE REMOVED
	POWARRANA ARTIFACT TO BE PROTECTED
	THREATENED VEGETATION TO BE RETAINED
	PROPOSED PROPERTY FENCELINE

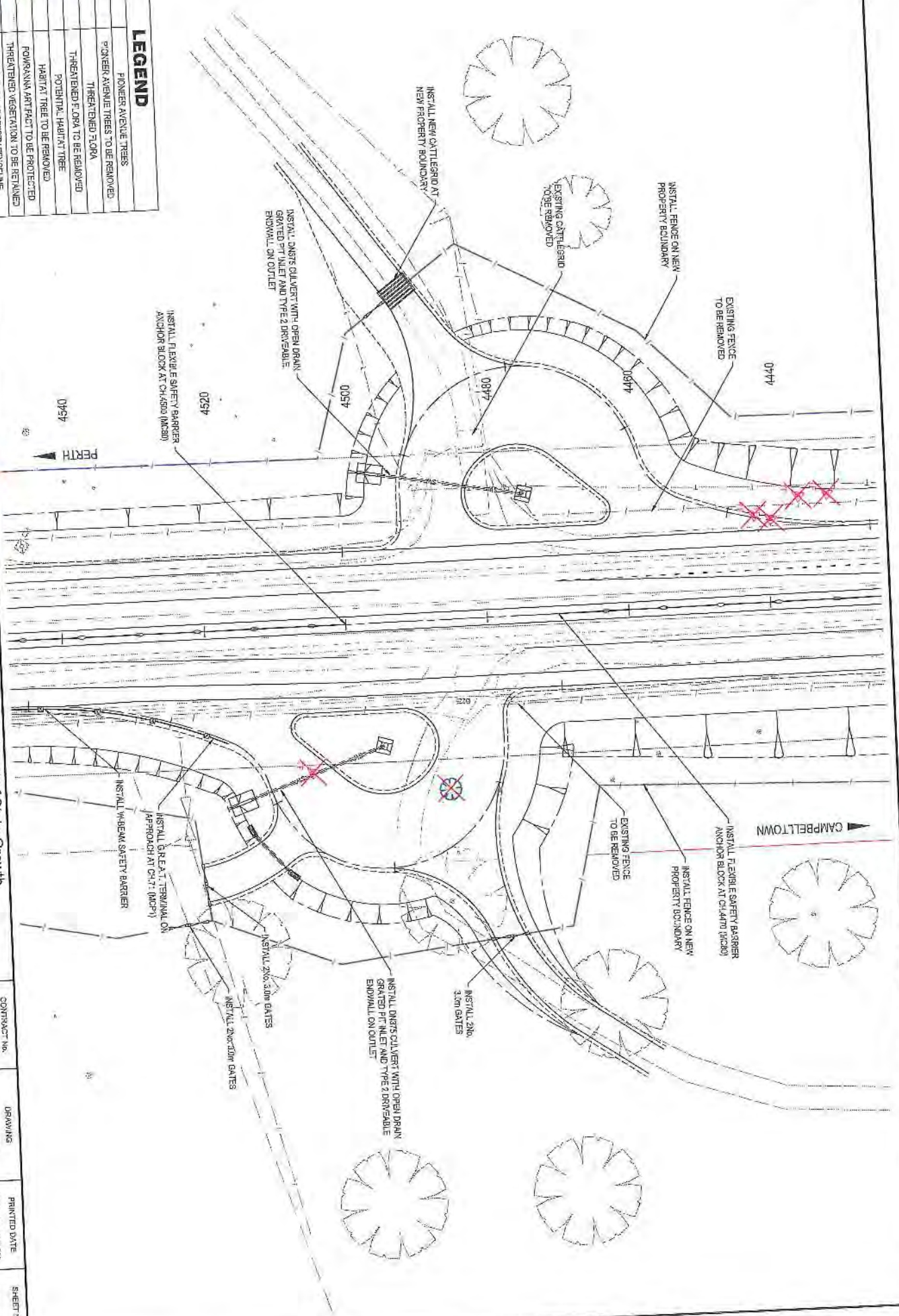

No.	Amendment Description	Initials	Date
A	PRELIMINARY DESIGN		
B	DEVELOPMENT APPLICATION ISSUE	N.D.WYER	10/01/2016
C	DEVELOPMENT APPLICATION ISSUE	N.D.WYER	07/10/2016
D	DEVELOPMENT APPLICATION ISSUE	N.D.WYER	13/10/2016

SCALES

1:500 (A3)

SCALE RATIO: 1:500

Horizontal Datum: A.M.S.

Coordinate System: WGA ZONE 55

DESIGNED	L. ALLEN
REVIEWED	N.D.WYER

Department of State Growth

MIDLAND HIGHWAY (A0087)

EPPING FOREST TO POWARRANA

ROAD IMPROVEMENTS AND SAFETY UPGRADES

DEVELOPMENT APPLICATION

JUNCTION DETAILS - DRG 3 OF 5

CONTRACT No.	2347	PRINTED DATE	17/06/16, 5:28 PM
REGISTRATION NUMBER	A0087.037	SHEET No.	268
URAWING	H1/5191-0288	REVISION	C

268

REVISION C

A3 original This sheet may be prepared using colour and may be incompatible if copied

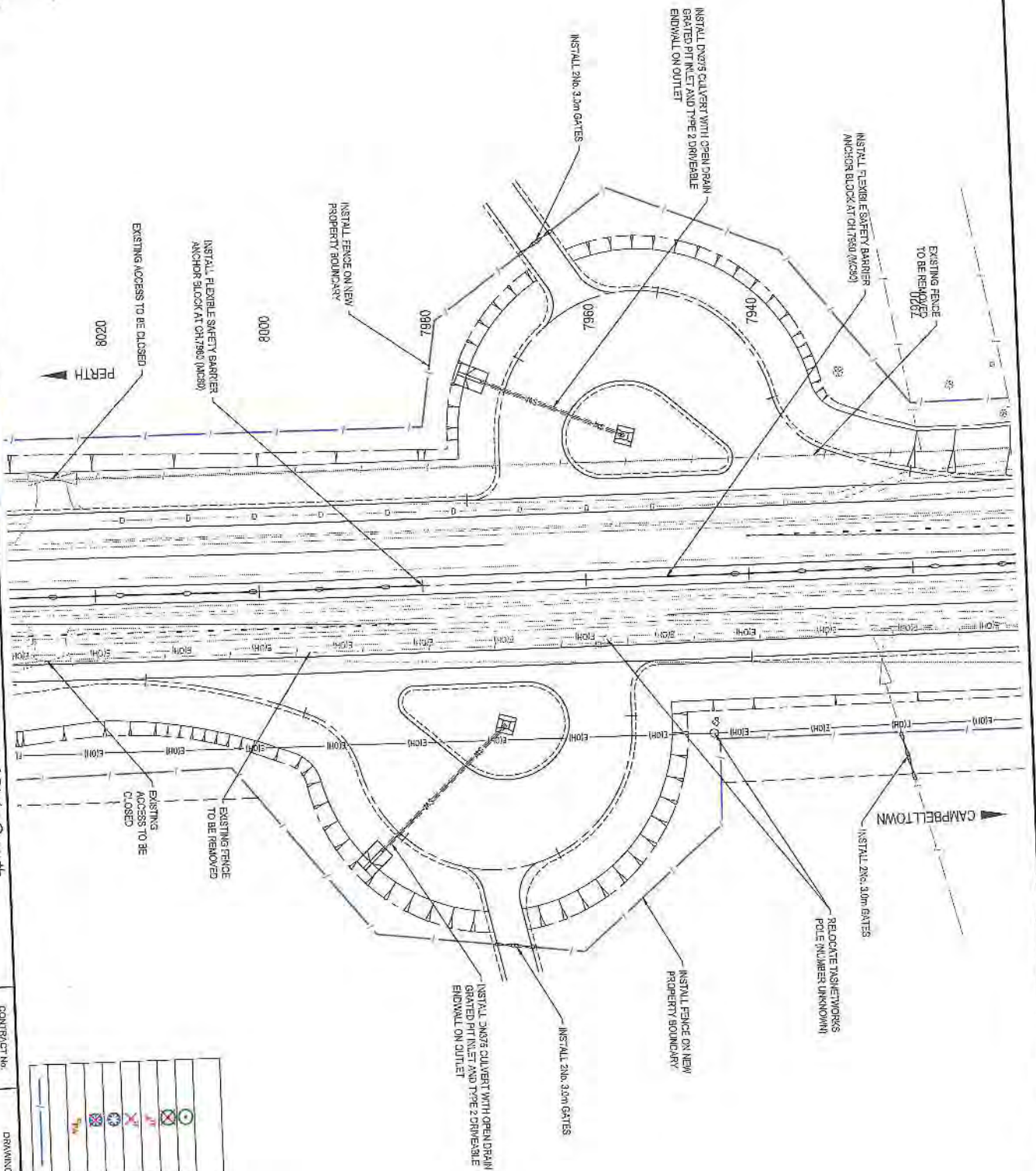

LEGEND	
	PIONEER AVENUE TREES
	PIONEER AVENUE TREES TO BE REMOVED
	THREATENED FLORA
	POTENTIAL HABITAT TREE
	HABITAT TREE TO BE REMOVED
	POMERANIAN ARTIFACT TO BE PROTECTED
	THREATENED VEGETATION TO BE RETAINED
	PROPOSED PROPERTY FENCE LINE

SCALES
1:500 (A3)
SCALE HORIZONTAL: 1:500
SCALE VERTICAL: 1:500

DESIGNED L. ALLEN
REVIEWED N. DWYER

Department of State Growth
MIDLAND HIGHWAY (A0087)
EPPING FORESTS TO POMERANIAN
ROAD IMPROVEMENTS AND SAFETY UPGRADES
DEVELOPMENT APPLICATION
JUNCTION DETAILS - DRG 4 OF 5

CONTRACT No. 2587
DRAWING H8181-0289
PRINTED DATE 17-Nov-16 3:58 PM

SHEET No. 269

No.	Revision Description	Date
A	PRELIMINARY DESIGN	13/10/2016
B	DEVELOPMENT APPLICATION ISSUE	01/11/2016
C	DEVELOPMENT APPLICATION ISSUE	01/11/2016
D	DEVELOPMENT APPLICATION ISSUE	01/11/2016

A3 Original The sheet may be prepared using colour and may be non-plotable. Contact

1-530



10811

11100

11120

11140

D. G. & R. J. KOTRBA
 LD - 218623
 TITLE - 1988314

D. G. & R. J. KOTRBA
 LD - 218623
 TITLE - 1988314

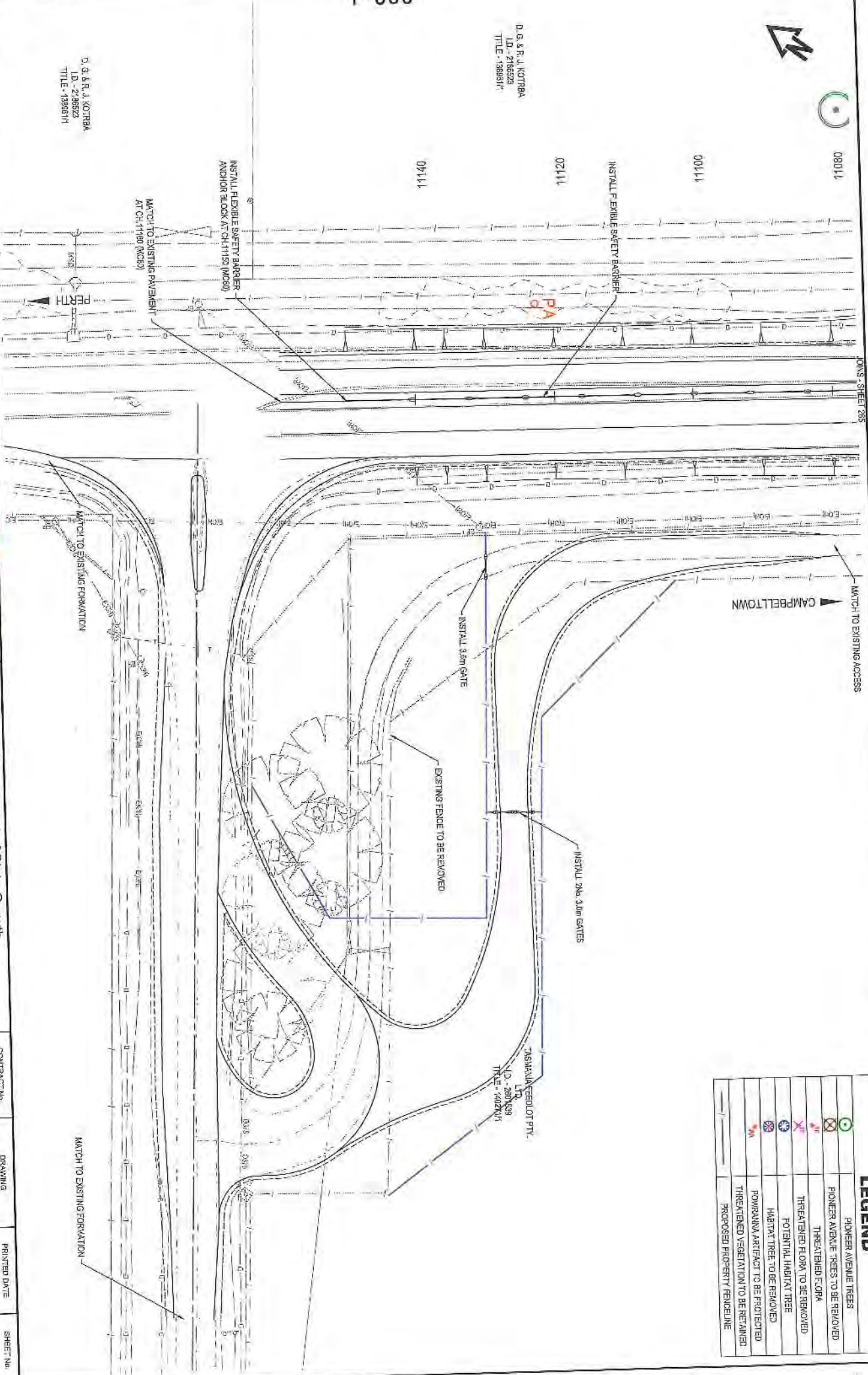

LEGEND	
	PIONEER AVENUE TREES
	PIONEER AVENUE TREES TO BE REMOVED
	THREATENED FLORA
	THREATENED FLORA TO BE REMOVED
	POTENTIAL HABITAT TREE
	HABITAT TREE TO BE REMOVED
	POWRANNA ARTIFACT TO BE PROTECTED
	THREATENED VEGETATION TO BE RETAINED
	PROPOSED PROPERTY BOUNDARY

No.	Amendment Description	Initials	Date
A. <td>PRELIMINARY DESIGN</td> <td></td> <td>13/02/2018</td>	PRELIMINARY DESIGN		13/02/2018
B. <td>DEVELOPMENT APPLICATION ISSUE</td> <td></td> <td>01/11/2018</td>	DEVELOPMENT APPLICATION ISSUE		01/11/2018
C. <td>DEVELOPMENT APPLICATION ISSUE</td> <td></td> <td>04/12/2018</td>	DEVELOPMENT APPLICATION ISSUE		04/12/2018
D. <td>UPDATED JOINS SHEET NUMBER</td> <td></td> <td>27/12/2018</td>	UPDATED JOINS SHEET NUMBER		27/12/2018

SCALES	
1:500 (A3)	
SCALE WITHIN: 1:50	

DESIGNED	REVIEWED
LALLEN	MADYFER

Department of State Growth
 MIDLAND HIGHWAY (A0087)
 EPPING FOREST TO POWRANNA
 ROAD IMPROVEMENTS AND SAFETY UPGRADES
 DEVELOPMENT APPLICATION
 JUNCTION DETAILS - DRG 5 OF 5

CONTRACT No.	DRAWING No.	PRINTED DATE	SHEET No.
2987	HR 419-C270	17-Nov-18, 3:38 PM	270
REGISTRATION NUMBER			REVISION ID
A0087.037			

This sheet may be prepared using AutoCAD and may be incomplete if copied.



Tasmanian Heritage Council
 GPO Box 618 Hobart Tasmania 7000
 103 Macquarie St, Hobart Tasmania 7000
 Tel: 1300 850 332
 enquiries@heritage.tas.gov.au
 www.heritage.tas.gov.au

ATTACHMENT B

PLANNING REF: P16-275
 EXEMPTION NO: 1259
 REGISTERED PLACE NO: 4995
 FILE NO: 10-47-52THC
 APPLICANT: Department of State Growth
 DATE: 21 November 2016

CERTIFICATE OF EXEMPTION

(Historic Cultural Heritage Act 1995)

The Place: 'Fairfield', 13790 Midland Highway, Epping Forest.

Thank you for your application for a Certificate of Exemption for works to the above place.

Your application has been approved by the Heritage Council under section 42(3)(a) of the Historic Cultural Heritage Act 1995 for the following works:

Works: Highway Upgrade.

Documents: Documents submitted as part of development application P16-275 including application form, plans A0087.037 203 Rev D and 204-221 Rev C and 267 Rev C by Pitt and Sherry (17/11/2016), and Development Application Supporting Report (November 2016).

Comments: The proposed works to upgrade the highway are well removed from the house and outbuildings, approximately 2km away. The works are therefore unlikely to impact on the historic cultural heritage values for which the place is registered and can be considered exempt.

A copy of this certificate will be forwarded to the local planning authority for their information. A planning, building or plumbing permit from the local planning authority may be required for the works. Further advice regarding these requirements should be obtained from the local council or planning authority.

Further information on the types of work that may be eligible for a Certificate of Exemption is available in the Tasmanian Heritage Council's Works Guidelines. The Guidelines can be downloaded from www.heritage.tas.gov.au

Please contact me on 1300 850 332 if you require further clarification of any details contained in this certificate.

Liz Fitzgerald
 Heritage Planner - Heritage Tasmania
 Under delegation of the Tasmanian Heritage Council

TR Ref: 2017- TR/NMC - 0258

Council Reference: P16-275

Level 2, 24 Murray Street
Hobart TAS 7001
PO Box 335
Kings Meadows TAS 7249
T 03 6227 5212
F 03 6227 5220
E landmanagement@tasrail.com.au
www.tasrail.com.au

General Manager
Northern Midlands Council
PO Box 156
Longford TAS 7301
Email: Planning@nmc.tas.gov.au

Dear Council,

RE: Notification for Midland Hwy Upgrade Powranna – Epping Forest

Thank you for the notification received by email on 10 January 2017 regarding the proposed Midland Highway upgrade between Powranna and Epping Forest.

The assessment by Council of the proposed development in relation to the Road and Railway Code supplied by the Department of State Growth is endorsed by TasRail.

Based on internal review of the documentation, TasRail does not believe the proposed Midland Highway upgrade will impact its rail operations or result in additional rail-related community impacts (eg horn noise).

Please be advised however, that TasRail will require the landowners proposing to use the four stock crossing underpasses to each enter into a Licence Agreement with TasRail. This is a simple document that sets the terms and conditions of authorised access through railway land and that will capture the proposed change in land survey following the land acquisition plan.

Should Council wish to discuss this matter further please email me at landmanagement@tasrail.com.au or direct telephone 6227 5212.

Yours sincerely,



Michael Ince
MANAGER PROPERTY SERVICES
16 January 2017

1-533

NORTHERN MIDLANDS COUNCIL

REPORT FROM:

HERITAGE ADVISER, DAVID DENMAN

DATE:

08-Nov-2016

REF NO:

P16-275;

SITE:

Midland Highway, Epping Forest

PROPOSAL:

**Midland Highway safety upgrade - Epping Forest to
Powranna**

**216211/1, 24230/1, 123739/1, 126228/1, 126657/2,
126661/1, 136123/2, 136124/2, 136126/1, 138371/1,
140271/1**

APPLICANT:

Department of State Growth

REASON FOR REFERRAL:

**HERITAGE-LISTED PLACE
Local Historic Heritage Code**

Do you have any objections to the proposal:

No

Do you have any other comments on this application?

The road upgrade will have no impact on the heritage values of the area or the heritage-listed places. There are no relevant development standards in the Local Historic Heritage Code



David Denman (Heritage Adviser)
Date: 11.1.2017

ATTACHMENT C

The General Manager
PO Box 156
LONGFORD TAS 7301

NORTHERN MIDLANDS COUNCIL						
Location						
File No.						
Property						
Attachments						
REC'D - 6 DEC 2016						
	J	A		J	A	
GM			NAV			
P&DM			CRS			
CSM			PLAN			
E&DM			BLD			
MM			PLT			
LR						

Date: 6-12-2016

JAMES EDWARD PREVOST wish to make a representation to planning application number PIG-273 on the following grounds:

- Request for truck access adjacent to new
- Round about - Double gates 2x4 meters wide
- to access title 250396/1 onto title 228148/1
-

Yours sincerely

James Prevost

James--76@hotmail.com
16 Bellevue Road Effing Forest.
0418322246.

Exhibited

1-535

LEGEND

	PIONEER AVENUE TREES
	PIONEER AVENUE TREES TO BE REMOVED
	THREATENED FLORA
	THREATENED FLORA TO BE REMOVED
	POTENTIAL HABITAT TREE
	POTENTIAL HABITAT TREE TO BE REMOVED
	HABITAT ARTFACT TO BE PROTECTED
	POWRANNA ARTFACT TO BE RETAINED
	THREATENED VEGETATION TO BE RETAINED
	PROPOSED PROPERTY FENCELINE

SHEET NO. 26

PRINTED DATE: 17-NOV-16, 3:58 PM

DRAWING: H16161-C226

CONTRACT No. 2687

REGISTRATION NUMBER: A0087.037

REGISTRATION NUMBER: A0087.037

REGISTRATION NUMBER: A0087.037

REGISTRATION NUMBER: A0087.037

REGISTRATION NUMBER: A0087.037

REGISTRATION NUMBER: A0087.037

REGISTRATION NUMBER: A0087.037

REGISTRATION NUMBER: A0087.037

REGISTRATION NUMBER: A0087.037

REGISTRATION NUMBER: A0087.037

REGISTRATION NUMBER: A0087.037

REGISTRATION NUMBER: A0087.037

REGISTRATION NUMBER: A0087.037

Department of State Growth

MIDLAND HIGHWAY (A0087)
EPPING FOREST TO POWRANNA
ROAD IMPROVEMENTS AND SAFETY
DEVELOPMENT APPLICATION
JUNCTION DETAILS - DRG 1 OF 5



SCALES
1:500 (A3)

CAMPBELLTOWN

PERTH

R. V. R. & K. M. HIGGINS
I.D. - 6228107
TITLE - 1103321

R. E. M. PREVOIST
I.D. - 6228173
TITLE - 2201481

R. E. M. PREVOIST
I.D. - 2284117
TITLE - 2502881

G. I. DAVIDSON
I.D. - 6206160
TITLE - 2182111

V. L. & L. M. JOHNSON
I.D. - 7130266
TITLE - 262201

REGRADE ACCESS AND SEAL TO PROPERTY BOUNDARY.
REPLACE EXISTING CULVERT WITH DN18 CULVERT WITH
TYPE 1 DRIVEABLE ENDWALLS

EXISTING TELSTRA PIT
TO BE RELOCATED

EXISTING FENCE
TO BE REMOVED

INSTALL FENCE ON NEW
PROPERTY BOUNDARY

EXISTING FENCE
TO BE REMOVED

RELOCATED TSN NETWORKS
POLE NO. 268640
CONSTRUCT ACCESS
TO MATCH TO EXISTING

INSTALL 3.6m GATE



CONSTRUCTION FORMATION

TSN NETWORKS POLE NO. 268640
TO BE RELOCATED

280

300

340

08C

08C



Erin Boer

Subject: FW: Epping Forest to Powranna_Extension of time letter, P16-275.pdf
Attachments: Midland Highway_Epping Forest to Powranna_Extension of Time for DA.PDF

From: Fry, Kathryn (StateGrowth) [<mailto:Kathryn.Fry@stategrowth.tas.gov.au>]
Sent: Monday, 19 December 2016 5:07 PM
To: Rosemary Jones <rosemary.jones@nmc.tas.gov.au>
Cc: NMC Planning <planning@nmc.tas.gov.au>; Conforti, Stefano (StateGrowth) <stefano.conforti@stategrowth.tas.gov.au>
Subject: Epping Forest to Powranna_Extension of time letter, P16-275.pdf

Dear Rosemary,

Re: Representation – Midland Highway Safety Upgrade – Epping Forest to Powranna.

Please be advised that State Growth does not intend to accommodate the representor's request for a new access and gates suitable for B-double vehicles on Belle Vue Road for the following reasons:

- The new access works are outside the scope of the project, being part of the Midland Highway Action Plan to upgrade the Midland Highway to improve road safety.
- Existing access to this property is not being affected by the project and the need for the new access works has not been demonstrated.
- Council is the road authority for Belle Vue Road and the landowner may seek to engage in discussions with Council regarding a new access on Belle Vue Road, as a separate process to the current Development Application.

State Growth supports withdrawal of the representation but will not be requesting formal mediation as per Council's letter.

The representor is welcome to contact State Growth's Project Manager, Stefano Conforti on 6166 3379 if they wish to seek clarification regarding the above advice.

Please find attached the signed Extension of Time.

Regards,
Kathryn

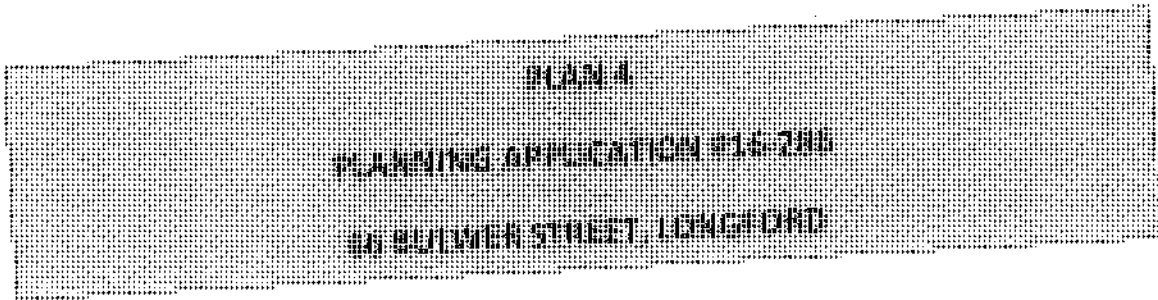

ATTACHMENTS

- A Application & plans
- B Representation



PO Box 156
 13 Smith Street
 Longford TAS 7301
 Email: council@nmc.tas.gov.au
 Web: www.northernmidlands.tas.gov.au

PH: 03 6397 7303
 FAX: 03 6397 7331

Base data from the LST, © State of Tasmania. For actual boundaries refer Title Plan boundaries refer TASMAR, © State of Tasmania where shown, aerial photography is indicative only and should not be used as an accurate comparison of title boundaries. Where shown, underground services are diagrammatic only. Actual location of services are to be confirmed on site.

66 Bulwer Street,
 Longford

14/11/2016

1:200



ATTACHMENT A

EXHIBITET

K. McCALL
PH. 63 911688

PROPOSED FRONT FENCE
FOR 66 BALWER ST
LAW-FORD.

1-539

1.5 COLOUR BOND CREAM SHEETS
C SECTION POSTS & RAILS
85 X 19 ml TIMBER SLATS
WITH 20 ml GAPS

GATES:
50 ml SQUARE
FRAME WITH 1 METRE
WIDE BY 1.8 HEIGHT.
ACCESS GATE

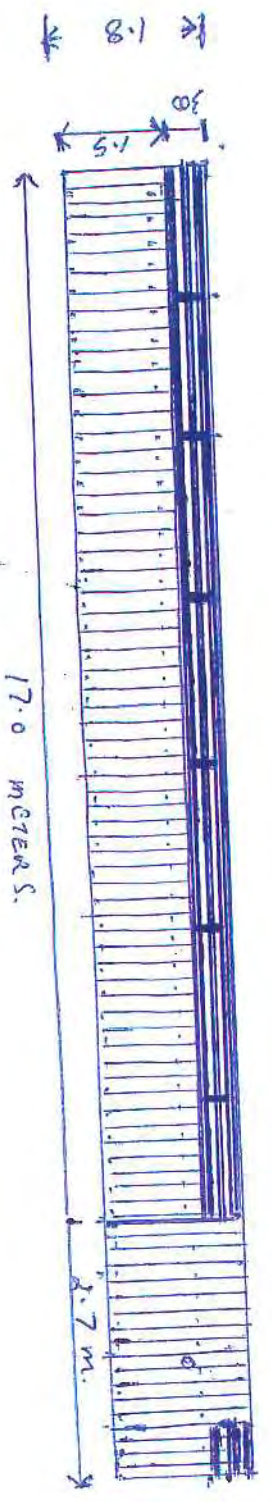

PA.

SEARCHED	INDEXED	SERIALIZED	FILED
REC'D 30 NOV 2016			
FBI - MEMPHIS			

1-540

EXHIBITED

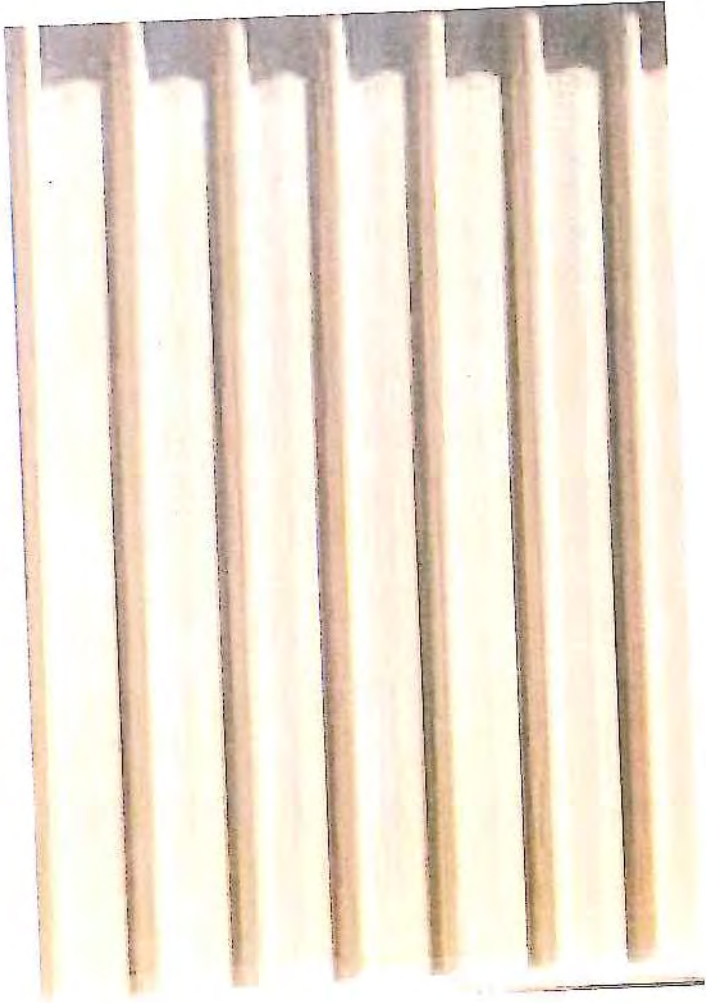

FENCE PROFILE EXAMPLE
~~~~~



# ATTACHMENT 1+54B

Mr Leslie Heath

64 Bulwer Street Longford Tasmania 7301

0414764314

[perfectcoffeblend@yahoo.com.au](mailto:perfectcoffeblend@yahoo.com.au)

| NORTHERN MIDLANDS DISTRICT |      |
|----------------------------|------|
| Location                   |      |
| File No.                   |      |
| Property                   |      |
| Attachments                |      |
| REC'D - 7 DEC 7006         |      |
| GM                         | NYE  |
| IP&DM                      | CRS  |
| CSM                        | PLAN |
| IP&DM                      | BLD  |
| WM                         | PLT  |
| VE                         |      |

To The General Manager,

I am writing this letter in response to the planning application Ref no P16-286.

I have issues with the planning request to have a 1.8m high solid colour bond fence and gates erected on the street frontage adjacent property to my own.

My reasons are as follows.

Firstly, the side fence between our two properties will slanted from a height of 1.7m at the building alignment down to 1.2m at street level (present height of both our front fences) causing an imbalance of continuity with the proposed 1.8m frontage and the far lesser height on the side. Secondly, a 1.8m front fence height is contrary to the majority of fences in the street. Third and most importantly, a fence of 1.8m will restrict the view of the road and footpath from my driveway when exiting. As a result posing a danger to road users and pedestrians who may be traveling along the street while me or my wife are exiting the drive way in our vehicles. This I believe is of a genuine concern because there are not only drivers and adults using the road but also young children who ride their bicycles along the street using not only the road but verge area also.

The resident who has submitted the application has only done so because of his concern that someone will take photographs of him working in the garden or on the house. He is of the opinion that if this was done, the photographs could be used against him in relationship to his disability pension.

I do not believe that his concerns in this matter warrant a 1.8m solid colour bond fence and gates to be erected across the full front of his property, especially when the side connecting fence will only be at a height of 1.2m.

Yours sincerely

Mr Leslie Heath

