

PLAN 9

DRAFT PLANNING SCHEME AMENDMENT 07/2018
6B Saundridge Road, Cressy

ATTACHMENTS:

- Heritage Adviser's comments
- Title

Paul Godier

From: David Denman <david@denman.studio>
Sent: Friday, 5 October 2018 3:38 PM
To: Paul Godier
Subject: RE: Grave sites - 6B Saundridge Rd, Cressy (adjacent to Holy Trinity Cressy)

Hi Paul,
Due to it's age and potential for the presence of unmarked graves on the site.
I recommend that the adjoining property at 6B Saundridge Road be included on the list of archaeologically significant sites.
Regards,
David

From: Paul Godier <paul.godier@nmc.tas.gov.au>
Sent: Thursday, 4 October 2018 12:00 PM
To: David Denman <david@denman.studio>
Subject: Grave sites - 6B Saundridge Rd, Cressy (adjacent to Holy Trinity Cressy)

Hello David, the grave sites on the far left shown in your Holy Trinity Heritage Assessment Report (p 2) are on an adjoining property.

They are on 6B Saundridge Road Cressy, owned by the Methodist Church.

Can you please advise if this property should also be included in the heritage list and on the list of archaeologically significant sites.

Thanks, Paul

Paul Godier



Senior Planner | Northern Midlands Council
Council Office, 13 Smith Street (PO Box 156), Longford Tasmania 7301
T: (03) 6397 7303 | F: (03) 6397 7331
E: paul.godier@nmc.tas.gov.au | W: www.northernmidlands.tas.gov.au

T a s m a n i a ' s H i s t o r i c H e a r t

Please note that due to the high volume of enquiries received, officers will be available for phone and face to face appointments to discuss building and planning matters at the following times:

- Monday – between 9:00am and 12:00pm
- Wednesday – between 2:00pm and 5:00pm
- Friday – between 9:00am and 12:00pm

For general enquiries please refer to the Fact Sheets located on our website at <http://northernmidlands.tas.gov.au>

Meetings can be arranged at other times by appointment.

Northern Midlands Council Confidentiality Notice and Disclaimer:The information in this transmission, including attachments, may be confidential (and/or protected by legal professional privilege), and is intended only for the person or

Issued Pursuant to the Land Titles Act 1980

20,000 ac. (card)
Robert James Dunbar
James Dunbar
Butler
Cavan
Adminstrator
DIAGRAM FROM ACTUAL SURVEY
8/4 T.N.
COUNTY OF
TOWNSHIP OF CRESSY
PARISH OF
REGISTERED NUMBER
92702



Scale 2 in chains to an inch.

Filed re Transfer of Tuxton sors to Waddingtons
CT XLIX Fol. 173

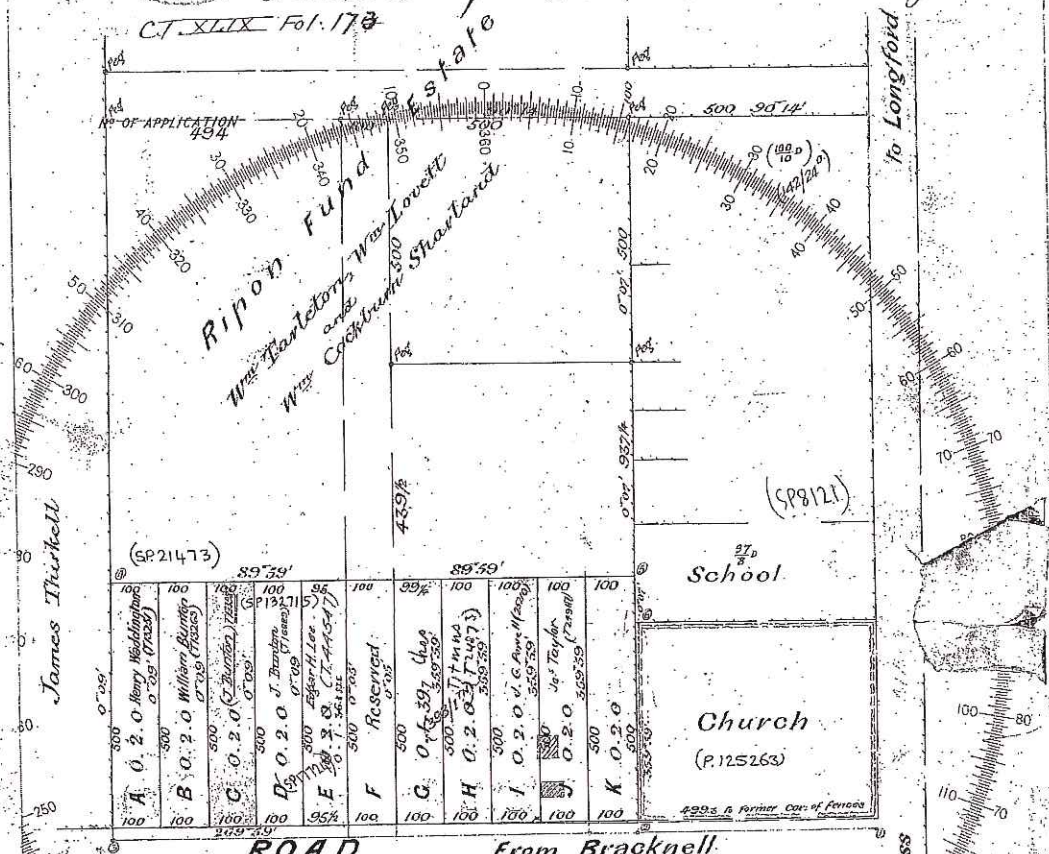

FOR TAPFOL TITLE PURPOSES	
EXISTING PLAN LOT No.	RENUMBERED FOLIO LOT No.
I	1
II	2
III	3
IV	4
V	5
VI	6
VII	7
VIII	8
IX	9
X	10
XI	11
XII	12
XIII	13
XIV	14
XV	15
XVI	16
XVII	17
XVIII	18
XIX	19
XX	20
XXI	21
XXII	22
XXIII	23
XXIV	24
XXV	25
XXVI	26
XXVII	27
XXVIII	28
XXIX	29
XXX	30
XXXI	31
XXXII	32
XXXIII	33
XXXIV	34
XXXV	35
XXXVI	36
XXXVII	37
XXXVIII	38
XXXIX	39
XXXX	40
XXXXI	41
XXXXII	42
XXXXIII	43
XXXXIV	44
XXXXV	45
XXXXVI	46
XXXXVII	47
XXXXVIII	48
XXXXIX	49
XXXXX	50
XXXXXI	51
XXXXXII	52
XXXXXIII	53
XXXXXIV	54
XXXXXV	55
XXXXXVI	56
XXXXXVII	57
XXXXXVIII	58
XXXXXIX	59
XXXXXX	60
XXXXXXI	61
XXXXXXII	62
XXXXXXIII	63
XXXXXXIV	64
XXXXXXV	65
XXXXXXVI	66
XXXXXXVII	67
XXXXXXVIII	68
XXXXXXIX	69
XXXXXXX	70
XXXXXXXI	71
XXXXXXXII	72
XXXXXXXIII	73
XXXXXXXIV	74
XXXXXXXV	75
XXXXXXXVI	76
XXXXXXXVII	77
XXXXXXXVIII	78
XXXXXXXIX	79
XXXXXXX	80
XXXXXXXI	81
XXXXXXXII	82
XXXXXXXIII	83
XXXXXXXIV	84
XXXXXXXV	85
XXXXXXXVI	86
XXXXXXXVII	87
XXXXXXXVIII	88
XXXXXXXIX	89
XXXXXXX	90
XXXXXXXI	91
XXXXXXXII	92
XXXXXXXIII	93
XXXXXXXIV	94
XXXXXXXV	95
XXXXXXXVI	96
XXXXXXXVII	97
XXXXXXXVIII	98
XXXXXXXIX	99
XXXXXXX	100

Date of instructions
Survey commenced
Survey finished
Error of close 1 in
Plotted by
Finally examined by
Entered on General Plan by

Report
George Theophilus Eadie of Tasmania, Authorized Surveyor under the Real Property Act, do hereby declare that the land herein delineated has been surveyed in accordance with the Regulations of the Surveyor General, and that the measurements are correct for the purposes of the Real Property Act.
District Surveyor
6th Dec 1892